

Hoods can be made with an Alumasteel bottom for use with ventilation power packs.
Custom hoods and modifications are available. Please provide a sketch.
Flush finished sides are standard on all range hoods.

BLANK FOR NOTES

M-Series Range Hoods

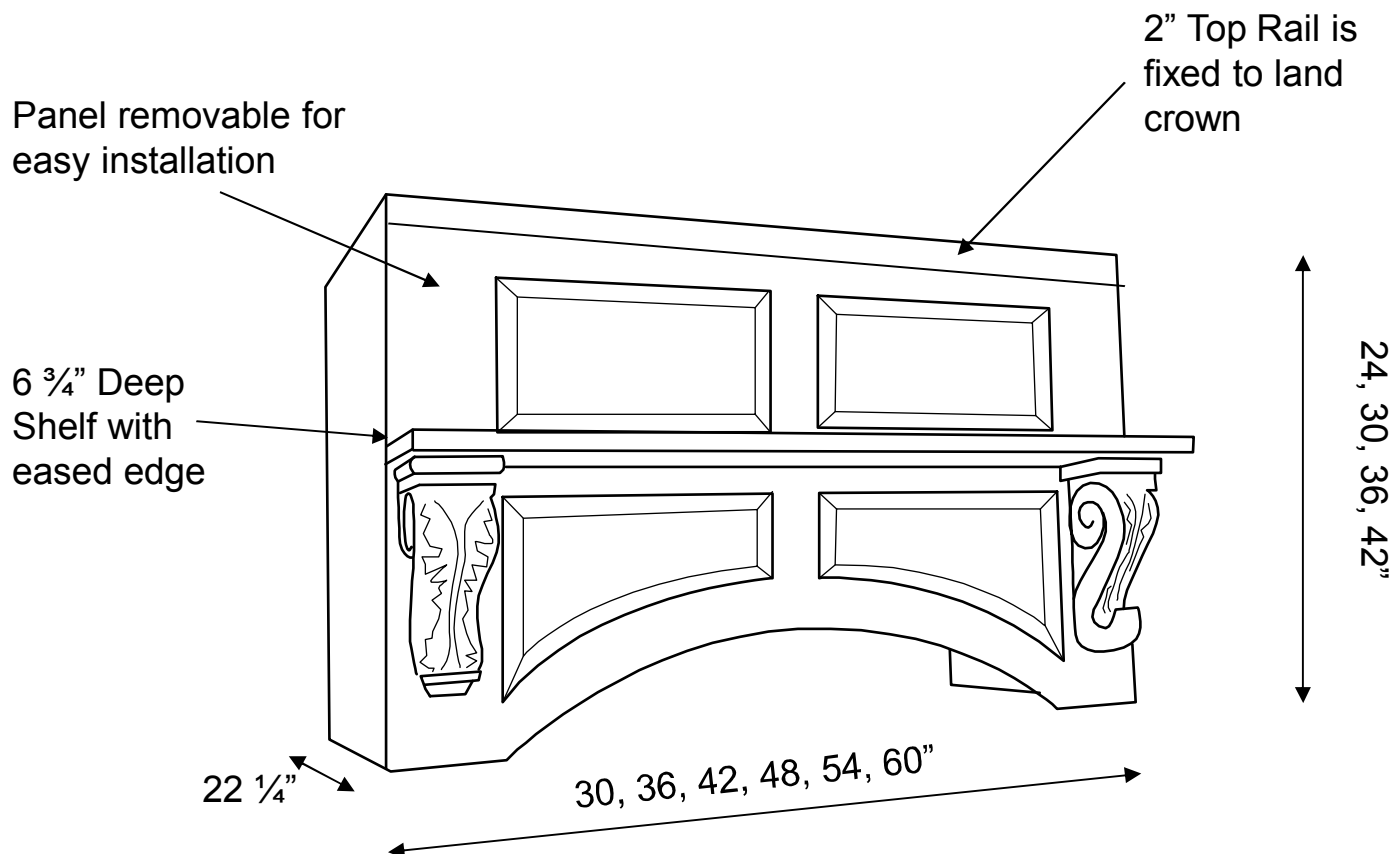

M Series hoods are available in standard widths to fit up to a 60" cook top. Custom widths and heights are available, custom depths are not.

The front panel is removable for easy installation.

Both the Professional liner and the Professional Mesh liner will fit the M-Series Hood. Several sizes and blower combinations are available. Order ventilation equal to the width of the hood.

Some variations of the M Series include corbels. Please see pages 3.8, 3.9 and 3.10 for available designs.

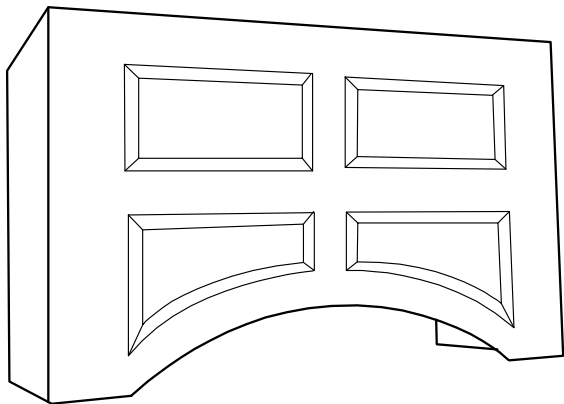

Standard M-Series Range Hood

24" HIGH	30" HIGH	36" HIGH	42" HIGH
WHM3024	WHM3030	WHM3036	WHM3042
WHM3624	WHM3630	WHM3636	WHM3642
WHM4224	WHM4230	WHM4236	WHM4242
WHM4824	WHM4830	WHM4836	WHM4842
WHM5424	WHM5430	WHM5436	WHM5442
WHM6024	WHM6030	WHM6036	WHM6042

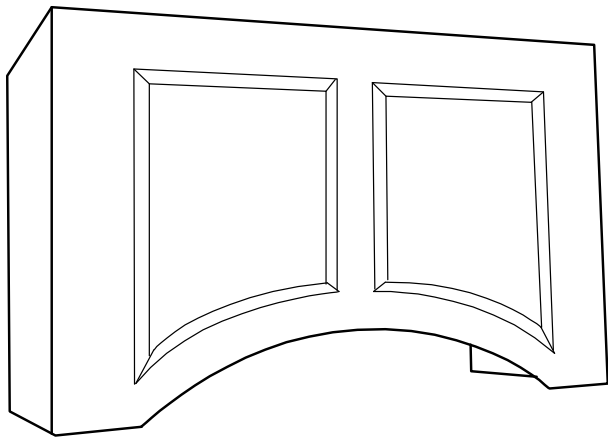

Double Panel M-Series Range Hood

24" HIGH	30" HIGH	36" HIGH	42" HIGH
WHMDP3024	WHMDP3030	WHMDP3036	WHMDP3042
WHMDP3624	WHMDP3630	WHMDP3636	WHMDP3642
WHMDP4224	WHMDP4230	WHMDP4236	WHMDP4242
WHMDP4824	WHMDP4830	WHMDP4836	WHMDP4842
WHMDP5424	WHMDP5430	WHMDP5436	WHMDP5442
WHMDP6024	WHMDP6030	WHMDP6036	WHMDP6042

M-SERIES WITH SHELF AND CORBELS (shown with acanthus corbels)

M-SERIES HOOD WITH SHELF AND CORBELS AS SHOWN

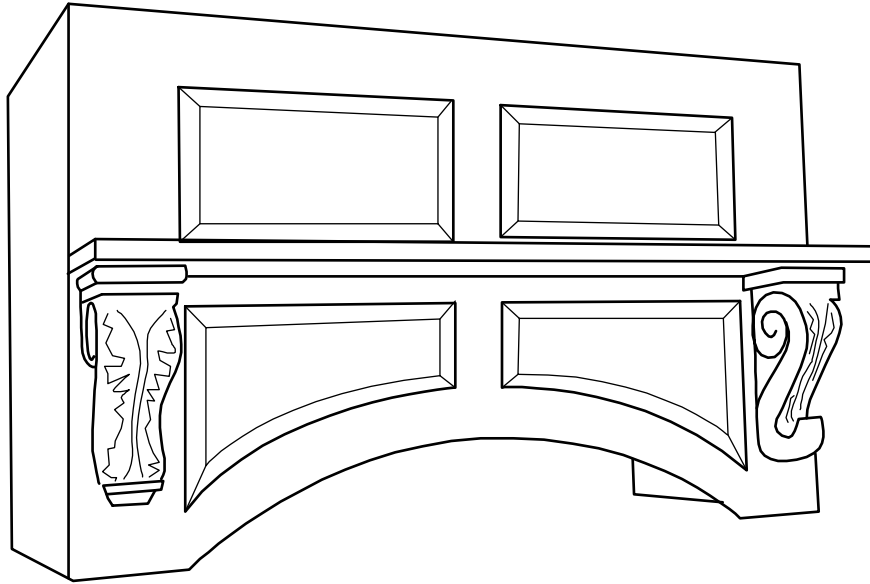
**ACANTHUS CORBEL**

24" HIGH	30" HIGH	36" HIGH	42" HIGH
WHMAC3024	WHMAC3030	WHMAC3036	WHMAC3042
WHMAC3624	WHMAC3630	WHMAC3636	WHMAC3642
WHMAC4224	WHMAC4230	WHMAC4236	WHMAC4242
WHMAC4824	WHMAC4830	WHMAC4836	WHMAC4842
WHMAC5424	WHMAC5430	WHMAC5436	WHMAC5442
WHMAC6024	WHMAC6030	WHMAC6036	WHMAC6042

M-SERIES HOOD WITH SHELF AND CORBELS AS SHOWN

TRADITIONAL CORBEL

24" HIGH	30" HIGH	36" HIGH	42" HIGH
WHMTT3024	WHMTT3030	WHMTT3036	WHMTT3042
WHMTT3624	WHMTT3630	WHMTT3636	WHMTT3642
WHMTT4224	WHMTT4230	WHMTT4236	WHMTT4242
WHMTT4824	WHMTT4830	WHMTT4836	WHMTT4842
WHMTT5424	WHMTT5430	WHMTT5436	WHMTT5442
WHMTT6024	WHMTT6030	WHMTT6036	WHMTT6042

GRAPE LEAF CORBEL

M-SERIES HOOD WITH SHELF AND CORBELS AS SHOWN



24" HIGH	30" HIGH	36" HIGH	42" HIGH
WHMGR3024	WHMGR3030	WHMGR3036	WHMGR3042
WHMGR3624	WHMGR3630	WHMGR3636	WHMGR3642
WHMGR4224	WHMGR4230	WHMGR4236	WHMGR4242
WHMGR4824	WHMGR4830	WHMGR4836	WHMGR4842
WHMGR5424	WHMGR5430	WHMGR5436	WHMGR5442
WHMGR6024	WHMGR6030	WHMGR6036	WHMGR6042

PROVINCIAL CORBEL

M-SERIES HOOD WITH SHELF AND CORBELS AS SHOWN

Provincial Corbels



24" HIGH	30" HIGH	36" HIGH	42" HIGH
WHMPSW3024	WHMPSW3030	WHMPSW3036	WHMPSW3042
WHMPSW3624	WHMPSW3630	WHMPSW3636	WHMPSW3642
WHMPSW4224	WHMPSW4230	WHMPSW4236	WHMPSW4242
WHMPSW4824	WHMPSW4830	WHMPSW4836	WHMPSW4842
WHMPSW5424	WHMPSW5430	WHMPSW5436	WHMPSW5442
WHMPSW6024	WHMPSW6030	WHMPSW6036	WHMPSW6042

ARTS & CRAFTS CORBEL

M-SERIES HOOD WITH SHELF AND CORBELS AS SHOWN



24" HIGH	30" HIGH	36" HIGH	42" HIGH
WHMART3024	WHMART3030	WHMART3036	WHMART3042
WHMART3624	WHMART3630	WHMART3636	WHMART3642
WHMART4224	WHMART4230	WHMART4236	WHMART4242
WHMART4824	WHMART4830	WHMART4836	WHMART4842
WHMART5424	WHMART5430	WHMART5436	WHMART5442
WHMART6024	WHMART6030	WHMART6036	WHMART6042

S-Series Range Hoods

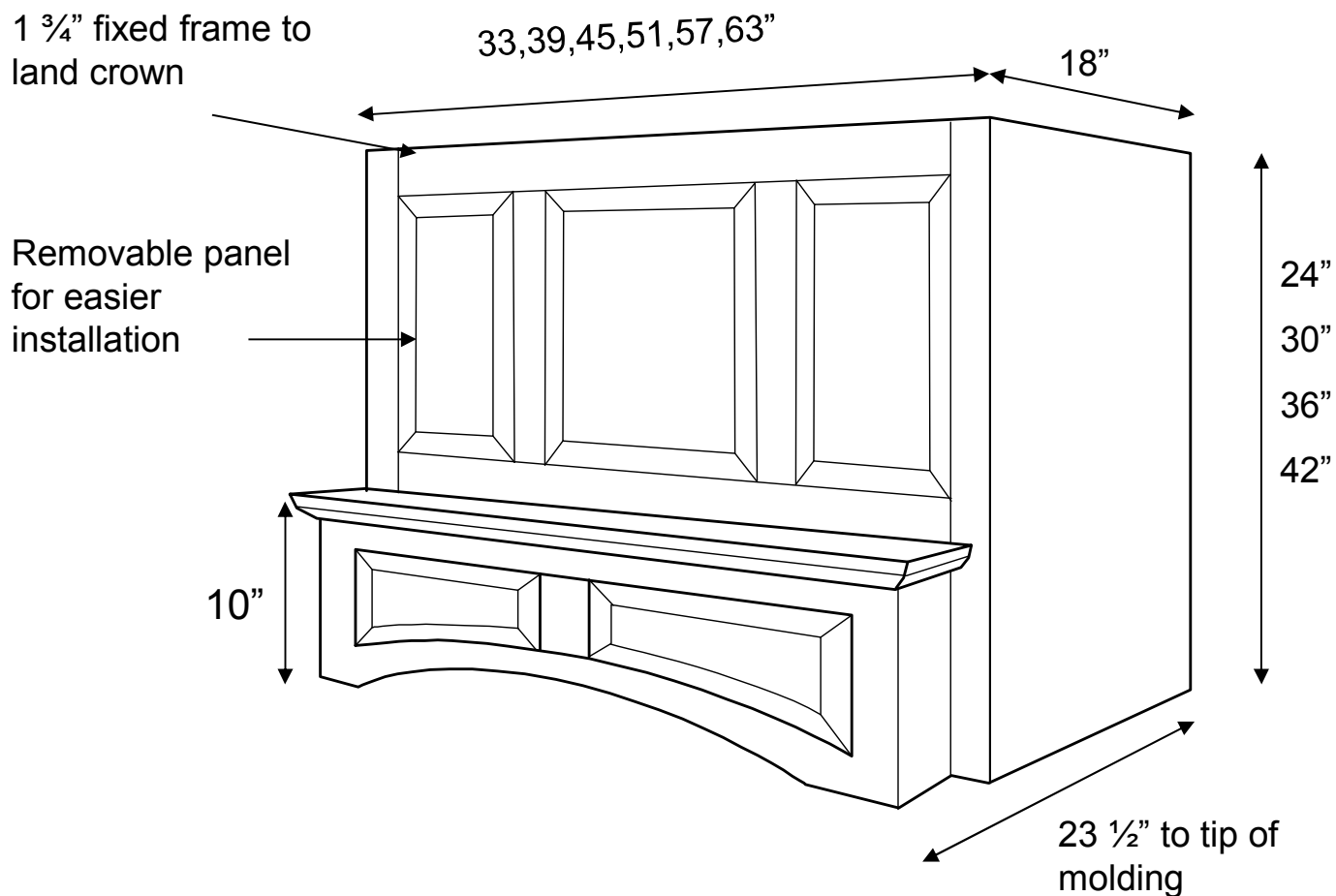

The S-Series is a popular mantle style hood . It's simple understated design compliments many kitchen styles.

S Series hoods are available in standard widths to fit up to a 60" cook top. Custom sizes are available.

The S Series must be at least 3" wider then the cooking surface it is covering. The panel above the mantle is removable for easy installation.

Both the Professional liner and the Professional Mesh liner will fit the S-Series Hood. Several sizes and blower combinations are available. Order ventilation 3" less than the width of the hood.

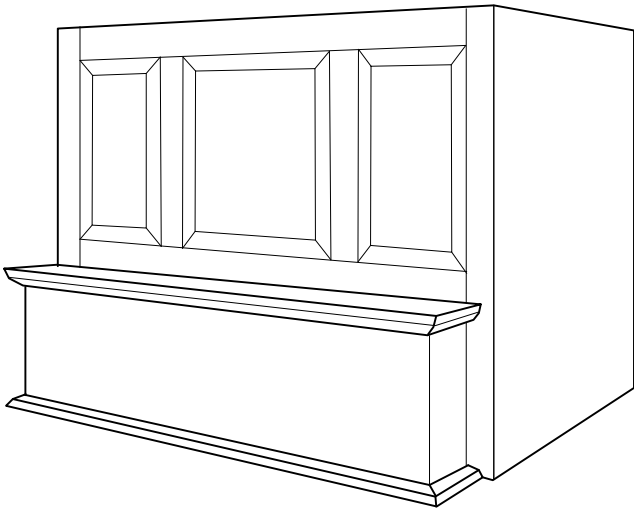

STANDARD S-SERIES

24" HIGH	30" HIGH	36" HIGH	42" HIGH
WHS3324	WHS3330	WHS3336	WHS3342
WHS3924	WHS3930	WHS3936	WHS3942
WHS4524	WHS4530	WHS4536	WHS4542
WHS5124	WHS5130	WHS5136	WHS5142
WHS5724	WHS5730	WHS5736	WHS5742
WHS6324	WHS6330	WHS6336	WHS6342

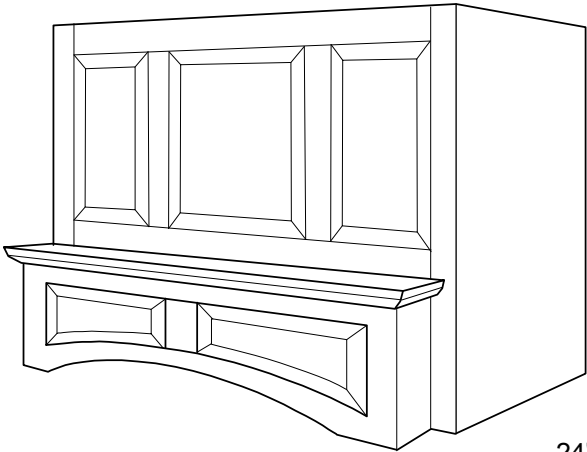

S-SERIES WITH ARCHED RAISED PANEL BASE

24" HIGH	30" HIGH	36" HIGH	42" HIGH
WHSRA3324	WHSRA3330	WHSRA3336	WHSRA3342
WHSRA3924	WHSRA3930	WHSRA3936	WHSRA3942
WHSRA4524	WHSRA4530	WHSRA4536	WHSRA4542
WHSRA5124	WHSRA5130	WHSRA5136	WHSRA5142
WHSRA5724	WHSRA5730	WHSRA5736	WHSRA5742
WHSRA6324	WHSRA6330	WHSRA6336	WHSRA6342

A-Series Range Hoods

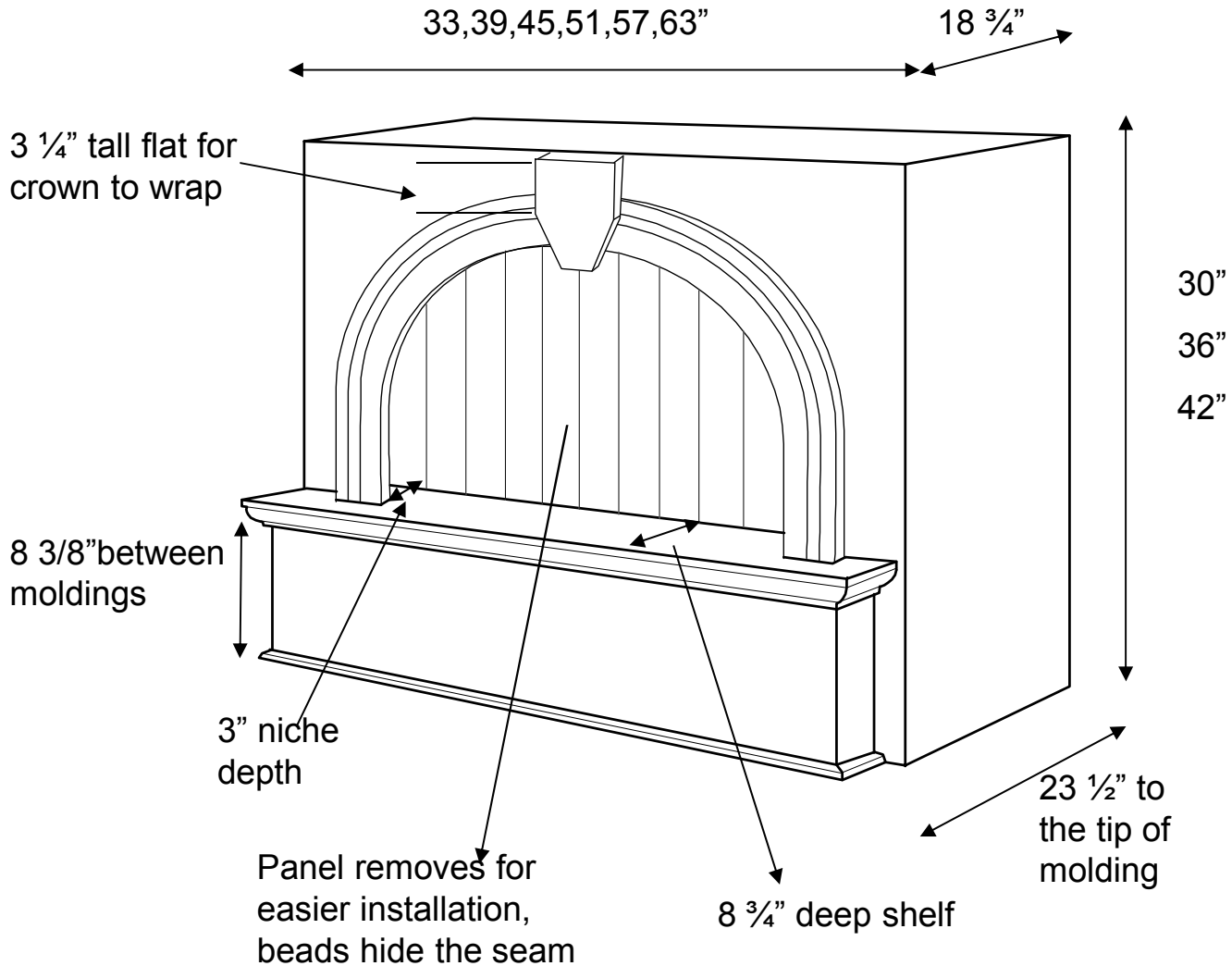

A Series hoods are available in standard widths to fit up to a 60" cook top. The bead board panel on the A-Series removes for ease of installation.

The A Series must be at least 3" wider than the cooking surface it is covering. The recess of the display niche fits 3" puck lights.

Both the Professional liner and the Professional Mesh liner will fit the A-Series Hood. Several sizes and blower combinations are available. Order ventilation 3" less than the width of the hood.

A-Series Range Hoods

STANDARD A SERIES

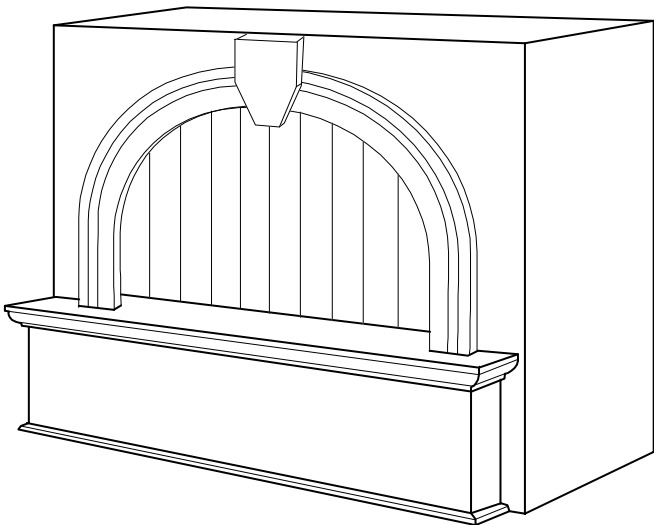

30" HIGH

- WHA3330
- WHA3930
- WHA4530
- WHA5130
- WHA5730
- WHA6330

36" HIGH

- WHA3336
- WHA3936
- WHA4536
- WHA5136
- WHA5736
- WHA6336

42" HIGH

- WHA3342
- WHA3942
- WHA4542
- WHA5142
- WHA5742
- WHA6342

A SERIES WITH ARCHED RAISED PANEL BASE

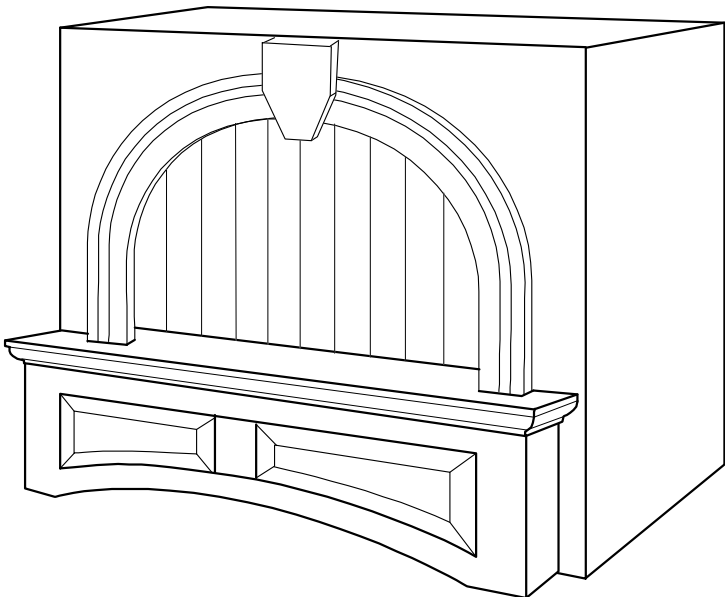

30" HIGH

- WHARA3330
- WHARA3930
- WHARA4530
- WHARA5130
- WHARA5730
- WHARA6330

36" HIGH

- WHARA3336
- WHARA3936
- WHARA4536
- WHARA5136
- WHARA5736
- WHARA6336

42" HIGH

- WHARA3342
- WHARA3942
- WHARA4542
- WHARA5142
- WHARA5742
- WHARA6342

Q-Series Range Hoods

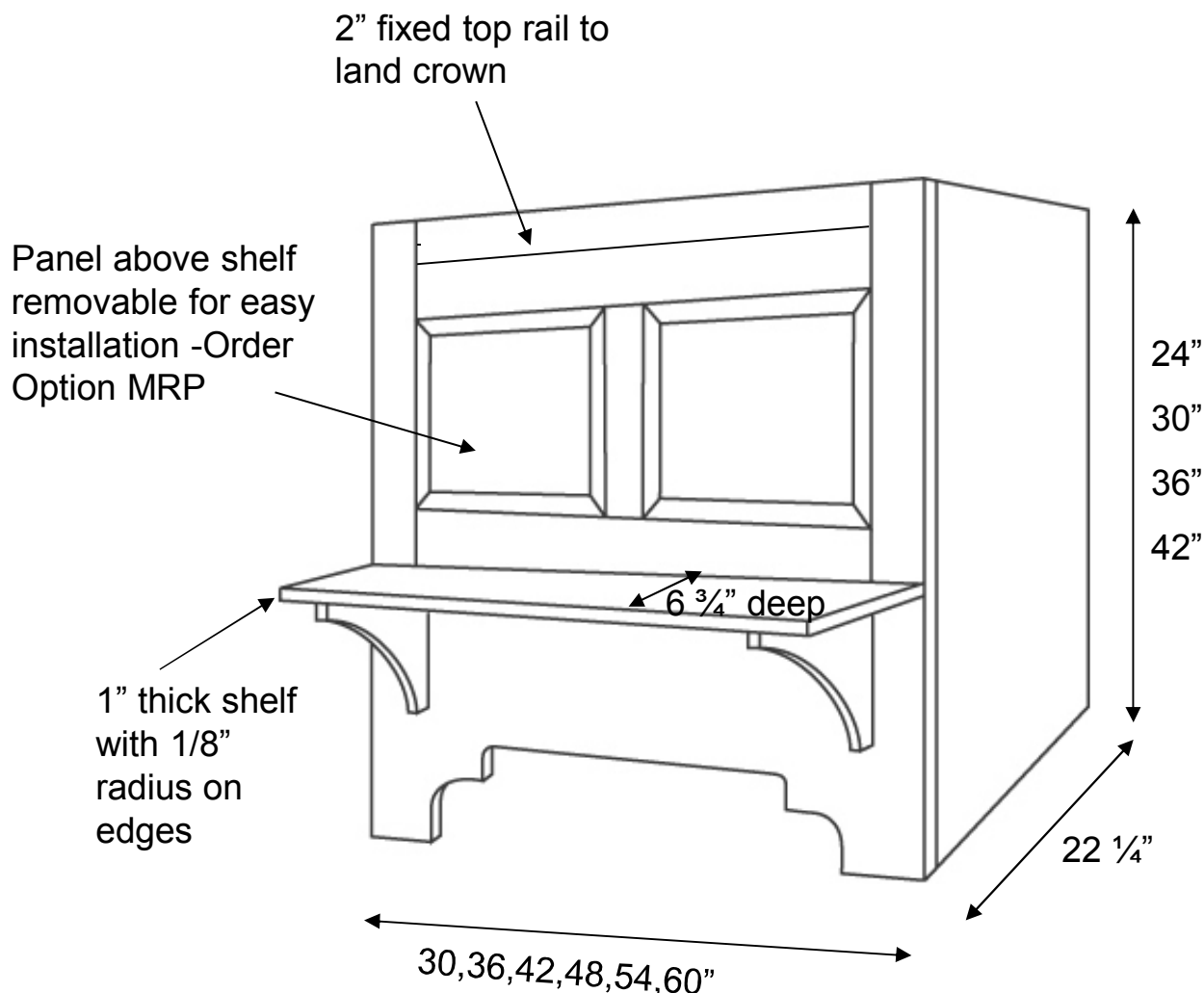

Q Series hoods are available in standard widths to fit up to a 60" cook top. Custom widths and heights are available, custom depths are not.

The front panel is removable for easy installation.

Both the Professional liner and the Professional Mesh liner will fit the Q-Series Hood. Several sizes and blower combinations are available. Order ventilation equal to the width of the hood.

The Q series comes with corbels. Please see page 3.16 for the available corbel designs.

Simple Brackets



Q-SERIES HOOD WITH SHELF AND CORBELS AS SHOWN

24" HIGH	30" HIGH	36" HIGH	42" HIGH
WHQBKT3024	WHQBKT3030	WHQBKT3036	WHQBKT3042
WHQBKT3624	WHQBKT3630	WHQBKT3636	WHQBKT3642
WHQBKT4224	WHQBKT4230	WHQBKT4236	WHQBKT4242
WHQBKT4824	WHQBKT4830	WHQBKT4836	WHQBKT4842
WHQBKT5424	WHQBKT5430	WHQBKT5436	WHQBKT5442
WHQBKT6024	WHQBKT6030	WHQBKT6036	WHQBKT6042

Provincial Corbels



Q-SERIES HOOD WITH SHELF AND CORBELS AS SHOWN

24" HIGH	30" HIGH	36" HIGH	42" HIGH
WHQPRS3024	WHQPRS3030	WHQPRS3036	WHQPRS3042
WHQPRS3624	WHQPRS3630	WHQPRS3636	WHQPRS3642
WHQPRS4224	WHQPRS4230	WHQPRS4236	WHQPRS4242
WHQPRS4824	WHQPRS4830	WHQPRS4836	WHQPRS4842
WHQPRS5424	WHQPRS5430	WHQPRS5436	WHQPRS5442
WHQPRS6024	WHQPRS6030	WHQPRS6036	WHQPRS6042

ARTS & CRAFTS CORBEL

Q-SERIES HOOD WITH SHELF AND CORBELS AS SHOWN



24" HIGH	30" HIGH	36" HIGH	42" HIGH
WHQART3024	WHQART3030	WHQART3036	WHQART3042
WHQART3624	WHQART3630	WHQART3636	WHQART3642
WHQART4224	WHQART4230	WHQART4236	WHQART4242
WHQART4824	WHQART4830	WHQART4836	WHQART4842
WHQART5424	WHQART5430	WHQART5436	WHQART5442
WHQART6024	WHQART6030	WHQART6036	WHQART6042

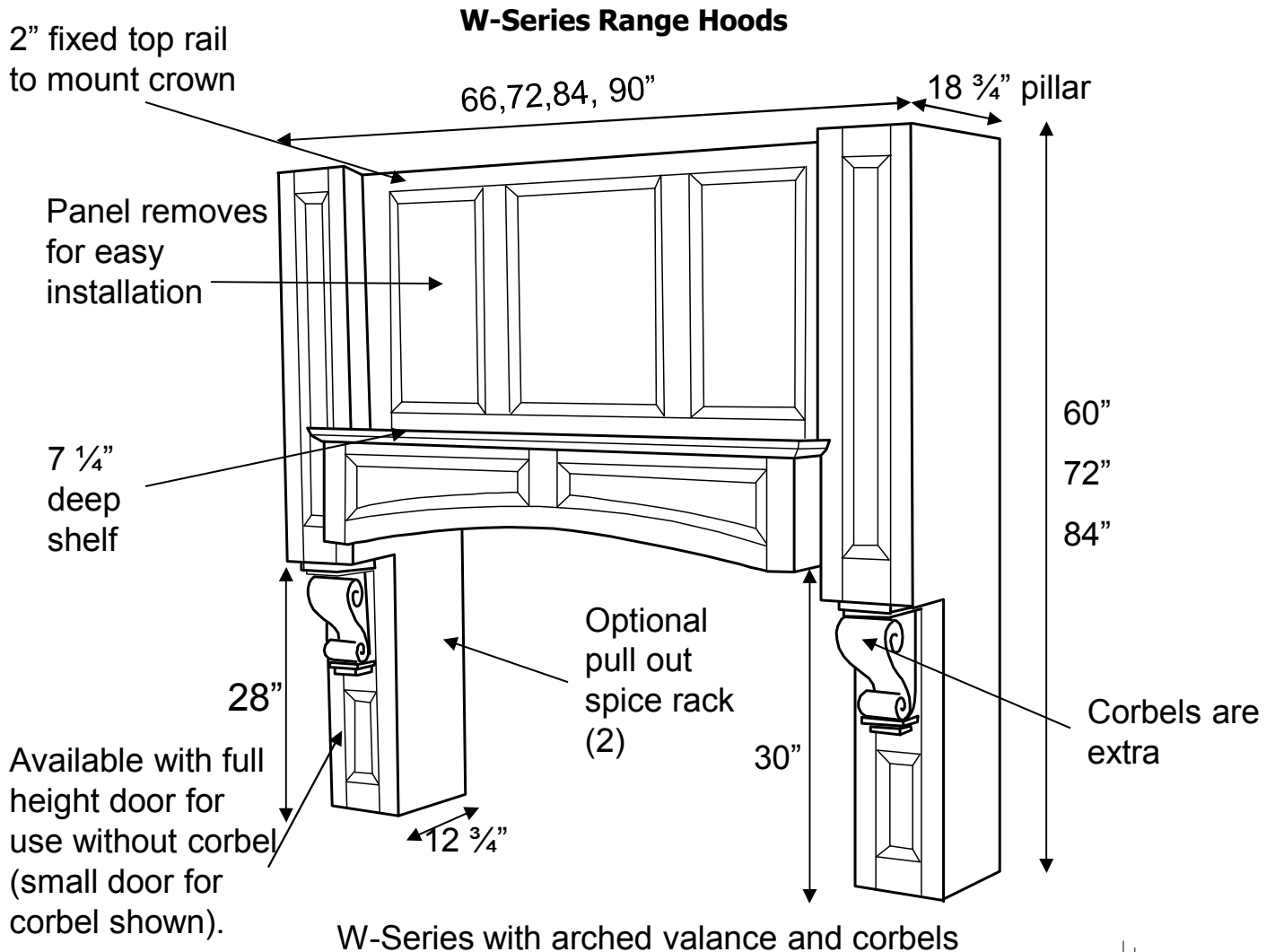

*See page 3.40 for selection of OPTIONAL corbels.

The W-Series is a hearth style hood that has columns which sit on the countertop. Please verify that there is enough distance between the column and the side of the cooking surface to meet the local code requirement. Custom sizes are available.

The columns can have optional pull-out spice racks, order WSR modification.

Optional corbels are available. Please see page 3.40 for the available corbels. Order these corbels as accessories.

The proper ventilation unit is one that is at least as wide as the cooking surface.

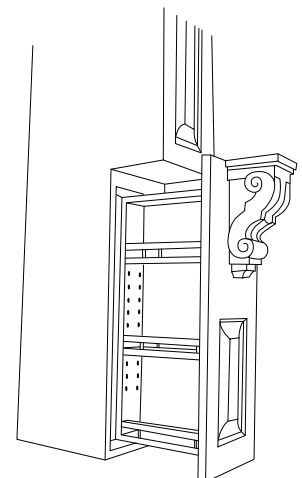

OPTION: WSR

**PULL-OUT
SPICE RACK**

WSRHOOD

STANDARD W-SERIES (OPTIONAL SPICE RACKS)

*See page 3.40 for selection of OPTIONAL corbels.

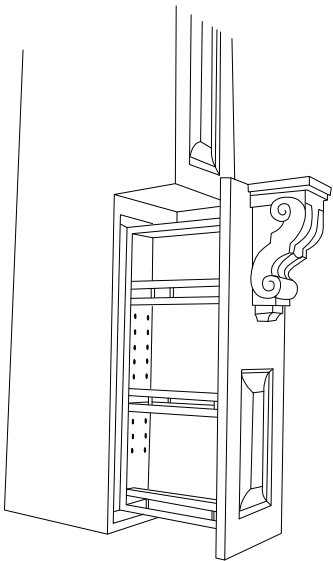
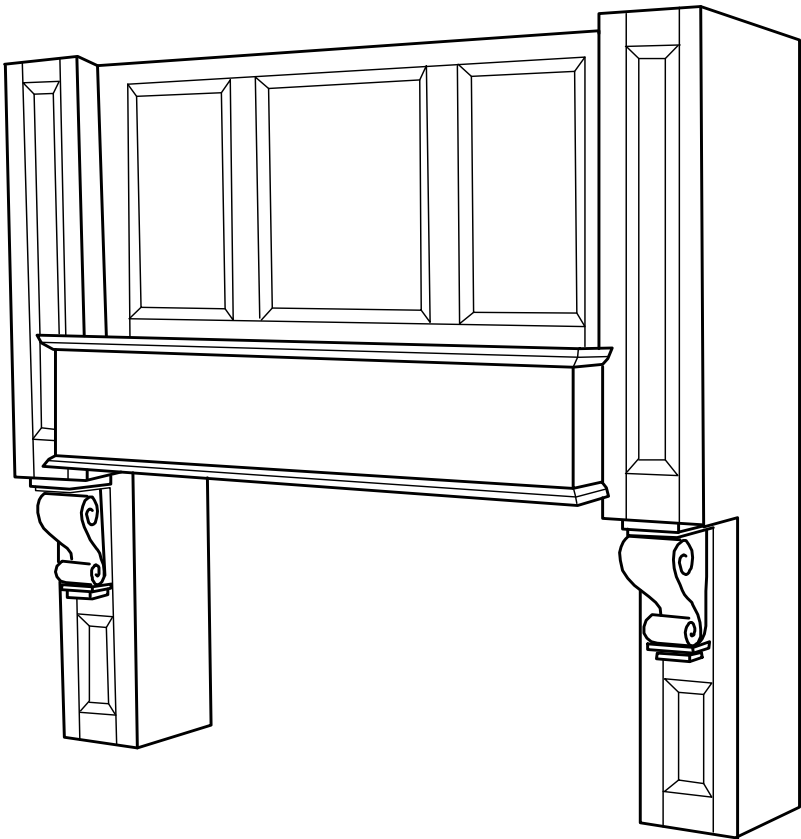

OPTION: WSR

**PULL-OUT
SPICE RACK**

WSRHOOD

60" HIGH	72" HIGH	84" HIGH
WHW6660	WHW6672	WHW6684
WHW7260	WHW7272	WHW7284
WHW8460	WHW8472	WHW8484
WHW9060	WHW9072	WHW9084

W-SERIES WITH ARCHED RAISED PANEL BASE (OPTIONAL SPICE RACKS)

*See page 3.40 for selection of OPTIONAL corbels.

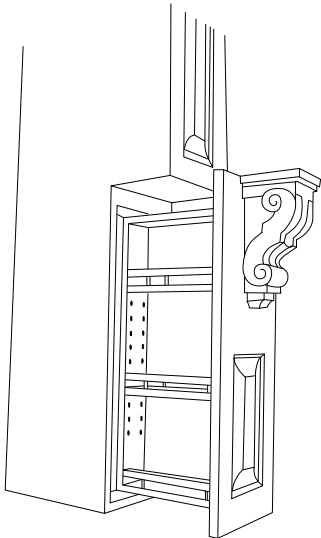
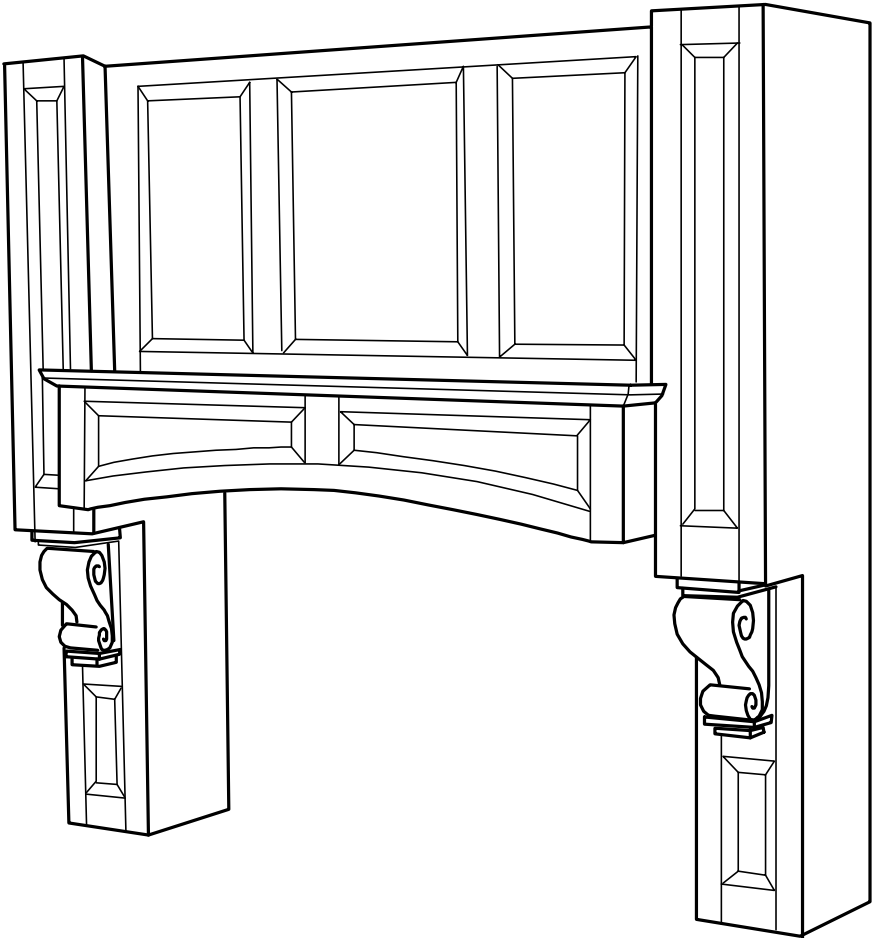

OPTION: WSR

PULL-OUT
SPICE RACK

WSRHOOD

60" HIGH	72" HIGH	84" HIGH
WHWRA6660	WHWRA6672	WHWRA6684
WHWRA7260	WHWRA7272	WHWRA7284
WHWRA8460	WHWRA8472	WHWRA8484
WHWRA9060	WHWRA9072	WHWRA9084

O-Series Range Hoods

Panel
removes for
easier
installation.
Beads hide
the seam.

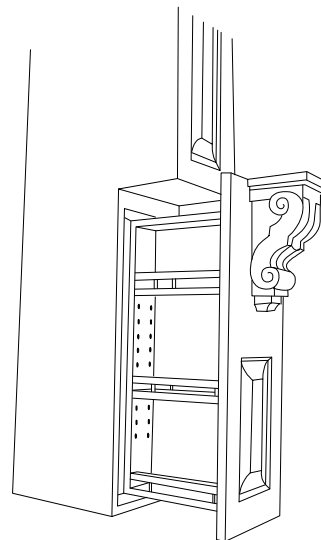
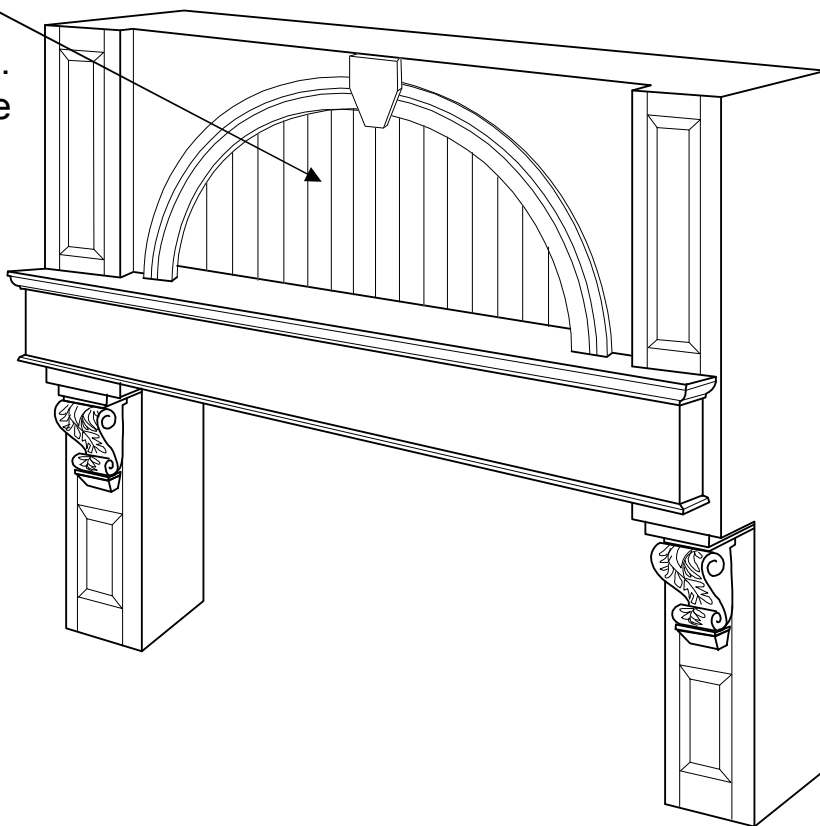

OPTION: WSR

**PULL-OUT
SPICE RACK**

WSRHOOD

*See page 3.40 for selection of OPTIONAL corbels.

The O-Series is a hearth style hood that has columns which sit on the countertop. Please verify that there is enough distance between the column and the side of the cooking surface to meet the local code requirement. Custom sizes are available.

The columns can have optional pull-out spice racks, order WSR modification.

Optional corbels are available. Please see page 3.40 for the available corbels. Order these corbels as accessories.

The proper ventilation unit is one that is at least as wide as the cooking surface.

STANDARD O-SERIES (SHOWN WITH OPTIONAL CORBELS)

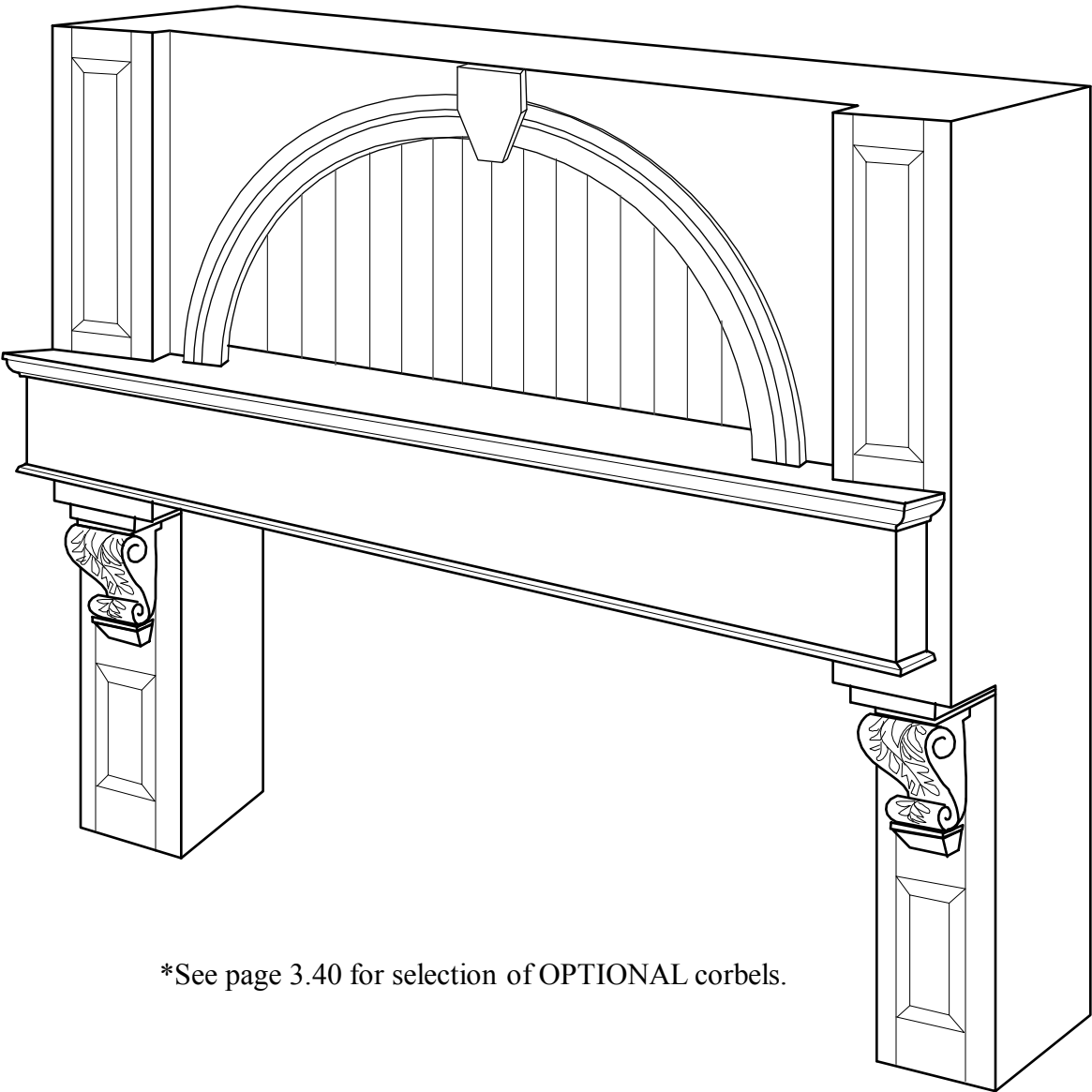

*See page 3.40 for selection of OPTIONAL corbels.

60" HIGH	72" HIGH	84" HIGH
WHO6660	WHO6672	WHO6684
WHO7260	WHO7272	WHO7284
WHO8460	WHO8472	WHO8484
WHO9060	WHO9072	WHO9084

O-SERIES ACANTHUS BASE & TOP (SHOWN WITH OPTIONAL CORBELS)

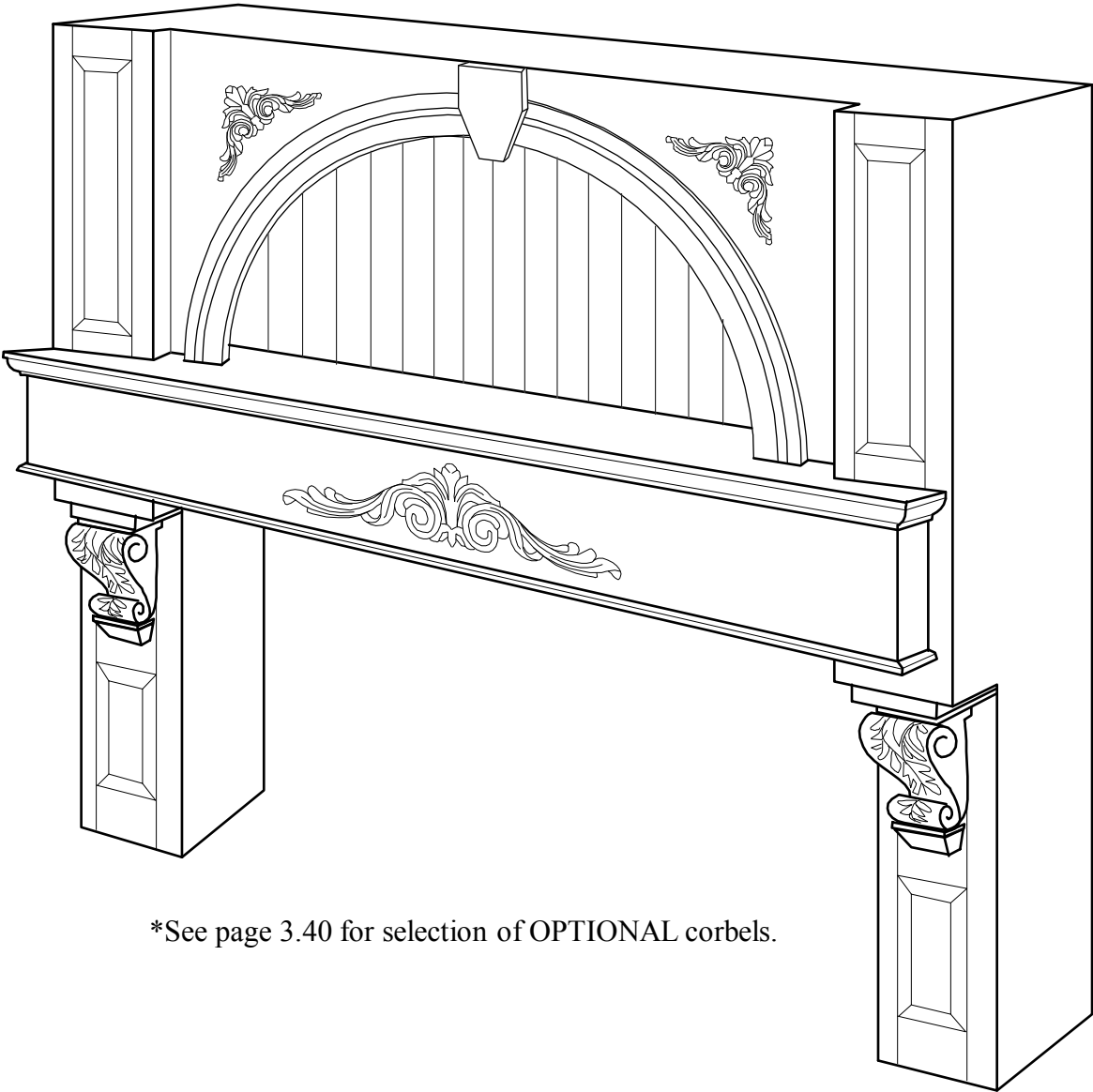

*See page 3.40 for selection of OPTIONAL corbels.

60" HIGH	72" HIGH	84" HIGH
WHOABT6660	WHOABT6672	WHOABT6684
WHOABT7260	WHOABT7272	WHOABT7284
WHOABT8460	WHOABT8472	WHOABT8484
WHOABT9060	WHOABT9072	WHOABT9084

G-Series Range Hoods

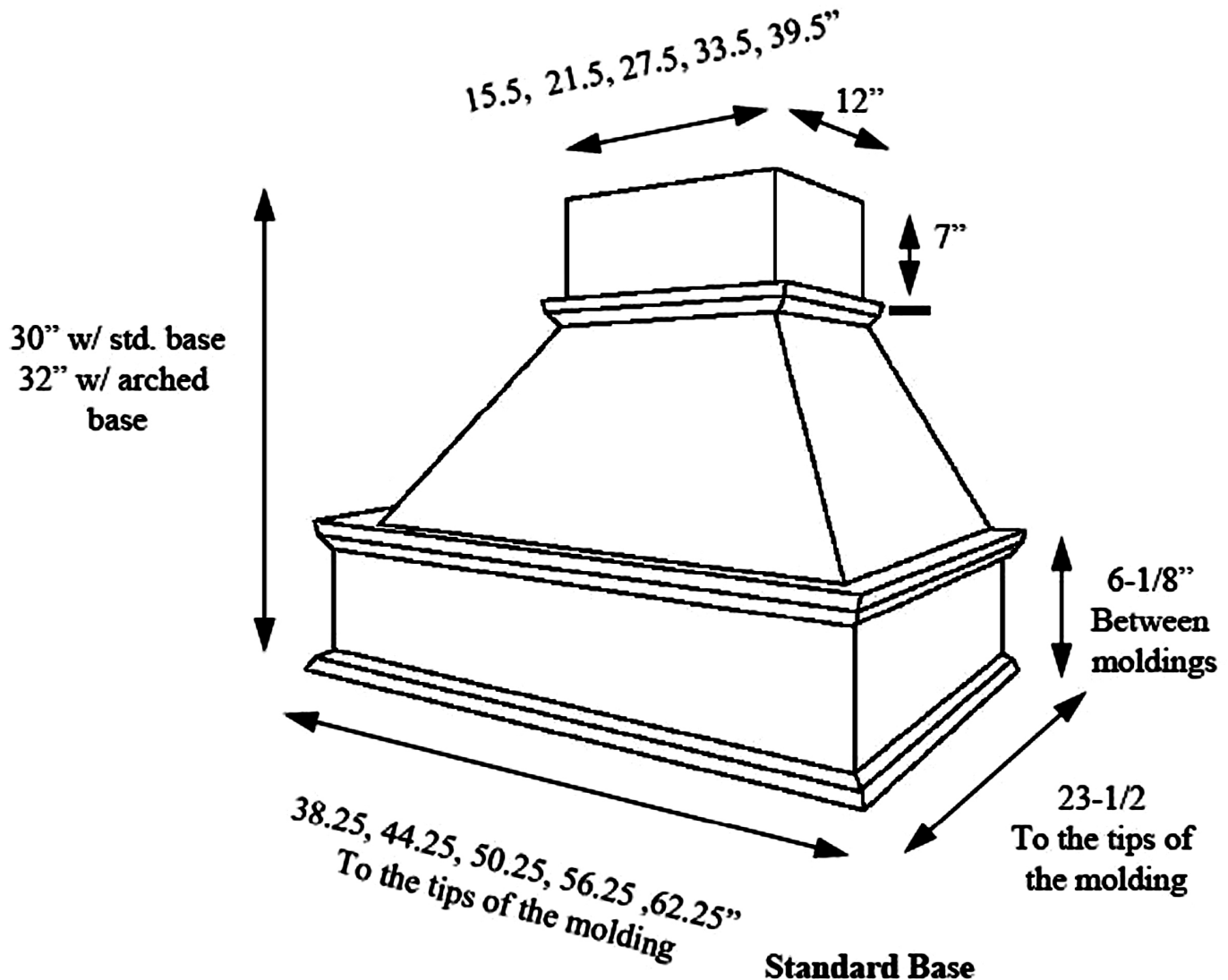

The G-series hood is sized to work with ranges up to 60". Custom widths are available, custom depths are not. The standard hood is designed for a 96" ceiling, although the chimney can be trimmed. Additional charges apply for extended chimney heights.

Order liners 2 1/4" smaller than the hood for proper fit (38 1/4" hood – order 36" liner)

G-Series Range Hoods

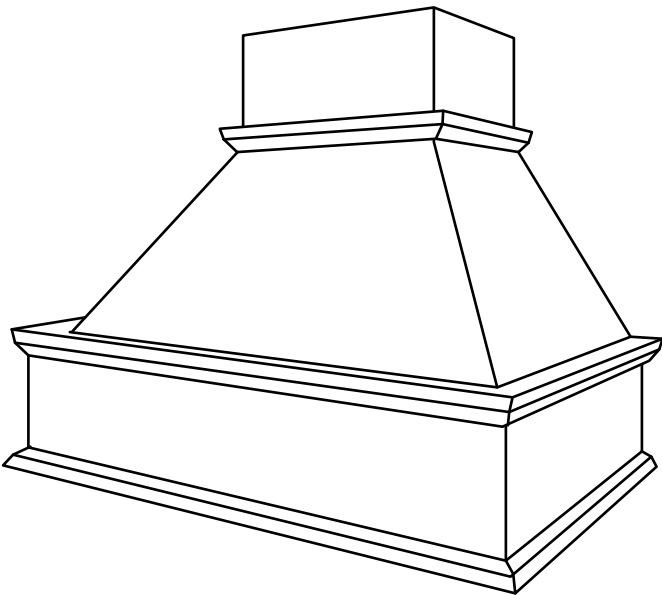

WHG

30" HIGH

32" HIGH

WHG38.2530	WHGRA38.2530
WHG44.2530	WHGRA44.2530
WHG50.2530	WHGRA50.2530
WHG56.2530	WHGRA56.2530
WHG62.2530	WHGRA62.2530

SIZED FOR 96" MAX CEILING HEIGHT.

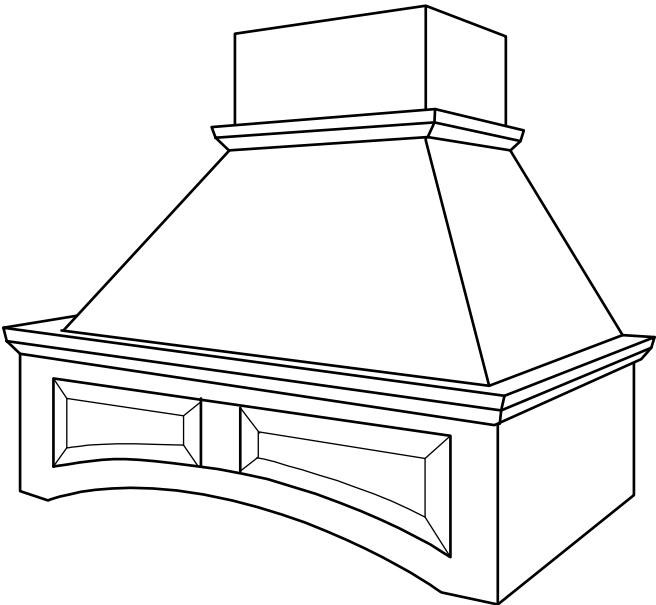

WHGRA

I-Series Range Hoods

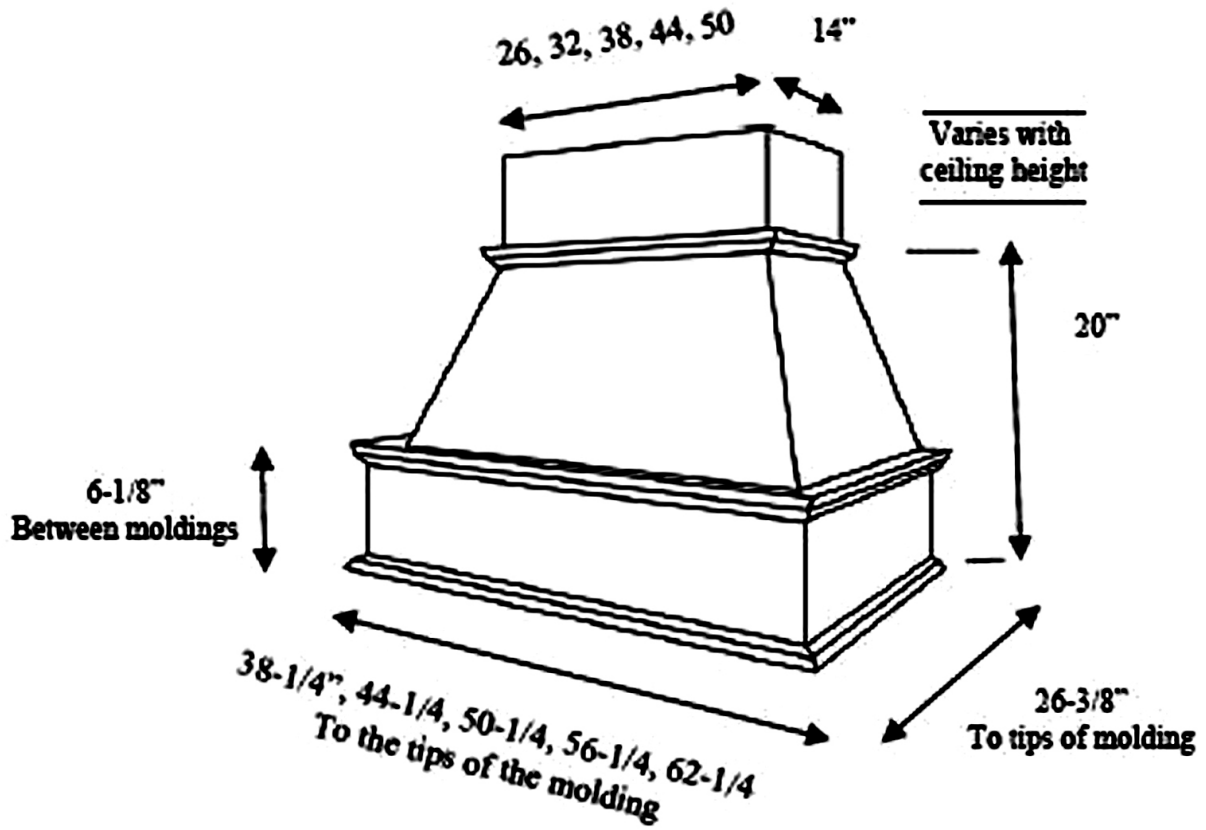

The I-series hood is sized to work with ranges up to 60". Custom heights are available, custom depths are not. The standard hood is designed to allow differing chimney heights to accommodate all standard ceiling heights.

Island hoods should be 6" larger than the cooking surface, if possible.

Order liners 2 1/4" smaller than the hood for proper fit (38 1/4" hood – order 36" liner)

I-Series Range Hoods

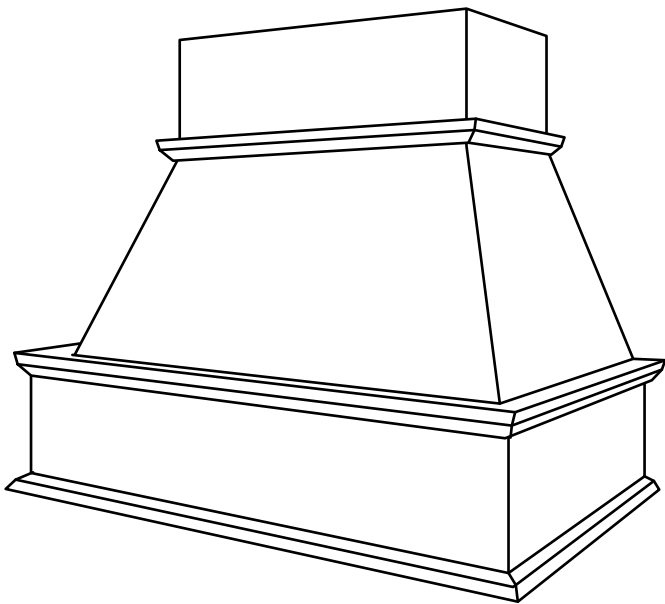

WHI

•1000 CFM Internal blower will not fit inside the 36” wide island hood.

WHI38.2520	WHIRA38.2520
WHI44.2520	WHIRA44.2520
WHI50.2520	WHIRA50.2520
WHI56.2520	WHIRA56.2520
WHI62.2520	WHIRA62.2520

SPECIFY CHIMNEY HEIGHT UPON ORDERING.

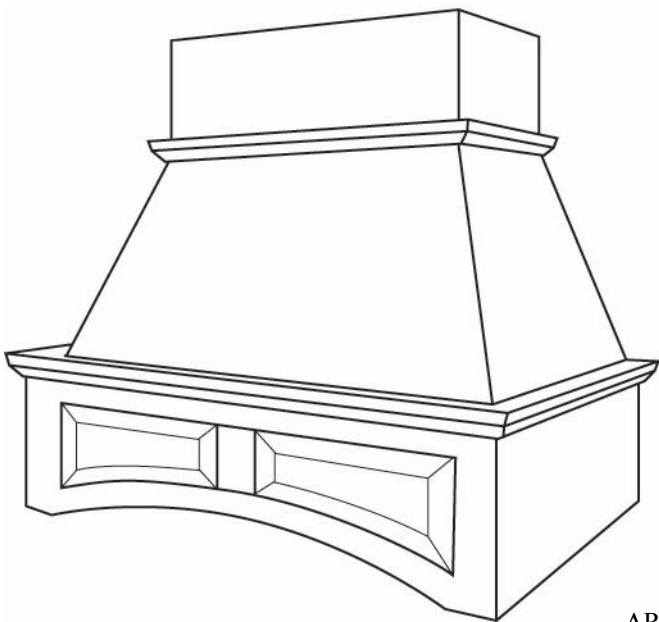

WHIRA

ARCHED RAISED PANEL BASE ON TWO SIDES

T-Series Range Hoods

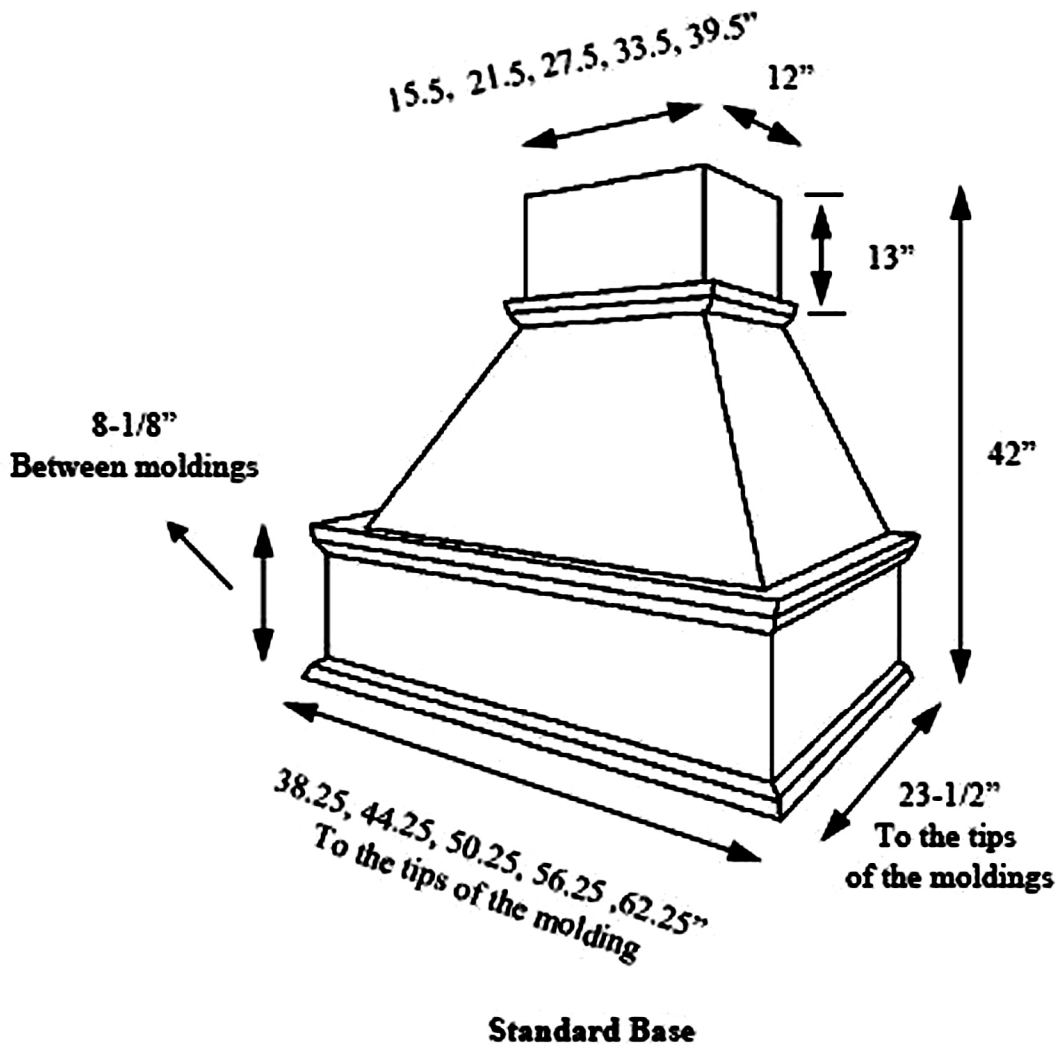

The T-series hood is sized to work with ranges up to 60". Custom heights are available, custom depths are not. The standard hood is designed for a 108" ceiling, although the chimney can be trimmed. Additional charges apply for extended chimney heights.

Order liners 2 1/4" smaller than the hood for proper fit (38 1/4" hood – order 36" liner)

T-Series Range Hoods

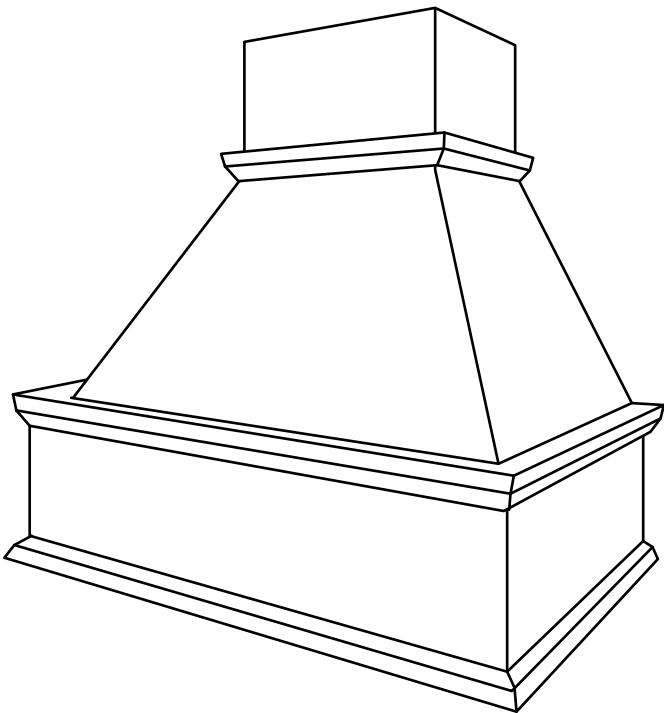

WHT

WHT38.2530	WHTRA38.2530
WHT44.2530	WHTRA44.2530
WHT50.2530	WHTRA50.2530
WHT56.2530	WHTRA56.2530
WHT62.2530	WHTRA62.2530

SIZED FOR 108" CEILING

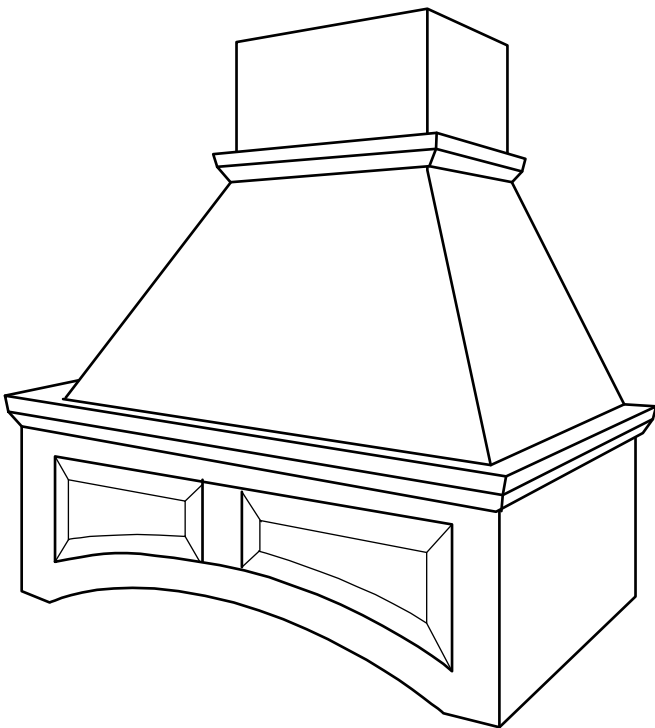

WHTRA

J-Series Range Hoods

MADE 12 1/2"

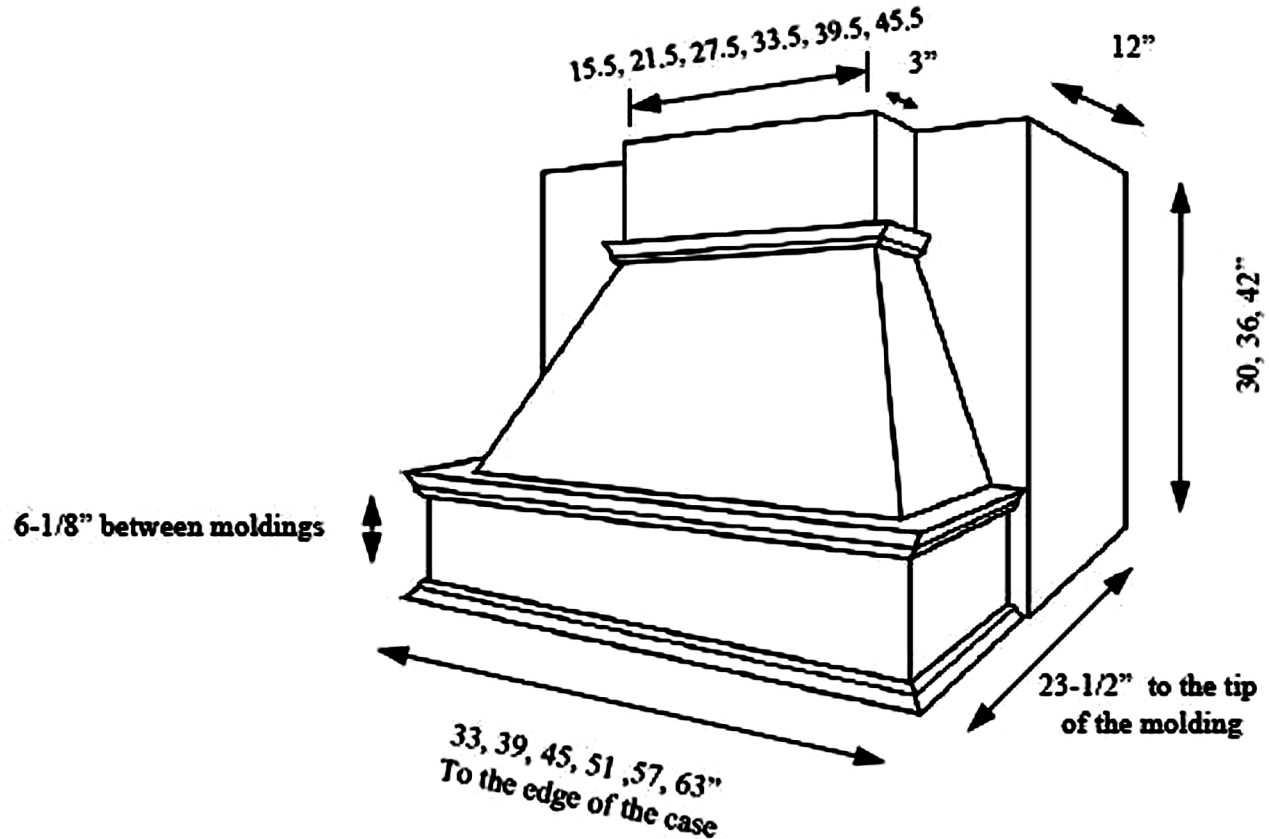

The J-series hood is designed to mount between wall cabinets. It allows the cabinet run to be continuous. It is sized to work with ranges up to 60". Custom heights are available, custom depths are not. The hood must be a minimum of 3" larger than the cooking surface.

Order liners 3" smaller than the hood for proper fit (39" hood – order 36" liner)

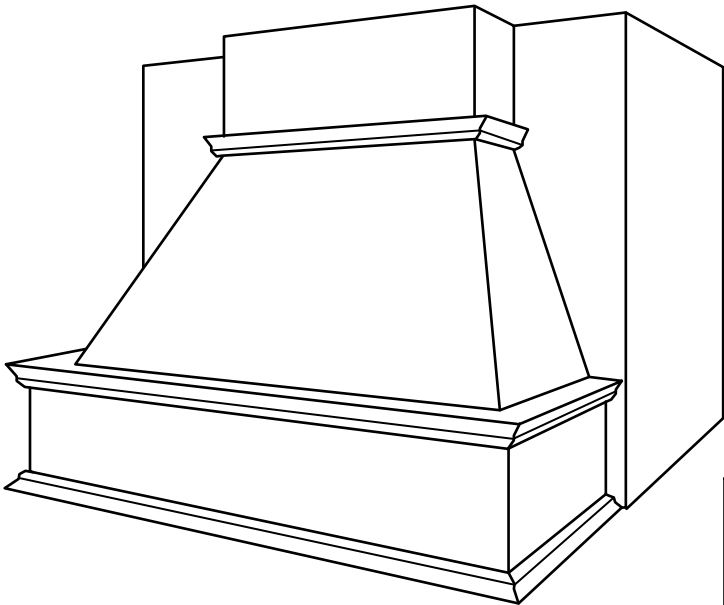

WHJ

30" HIGH	36" HIGH	42" HIGH
WHJ3330	WHJ3336	WHJ3342
WHJ3930	WHJ3936	WHJ3942
WHJ4530	WHJ4536	WHJ4542
WHJ5130	WHJ5136	WHJ5142
WHJ5730	WHJ5736	WHJ5742
WHJ6330	WHJ6336	WHJ6342

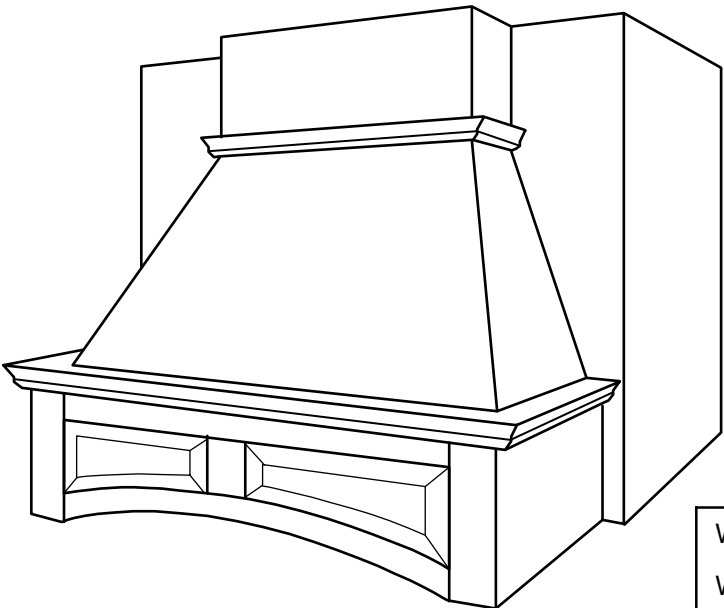

WHJRA

30" HIGH	36" HIGH	42" HIGH
WHJRA3330	WHJRA3336	WHJRA3342
WHJRA3930	WHJRA3936	WHJRA3942
WHJRA4530	WHJRA4536	WHJRA4542
WHJRA5130	WHJRA5136	WHJRA5142
WHJRA5730	WHJRA5736	WHJRA5742
WHJRA6330	WHJRA6336	WHJRA6342

D-Series Range Hoods

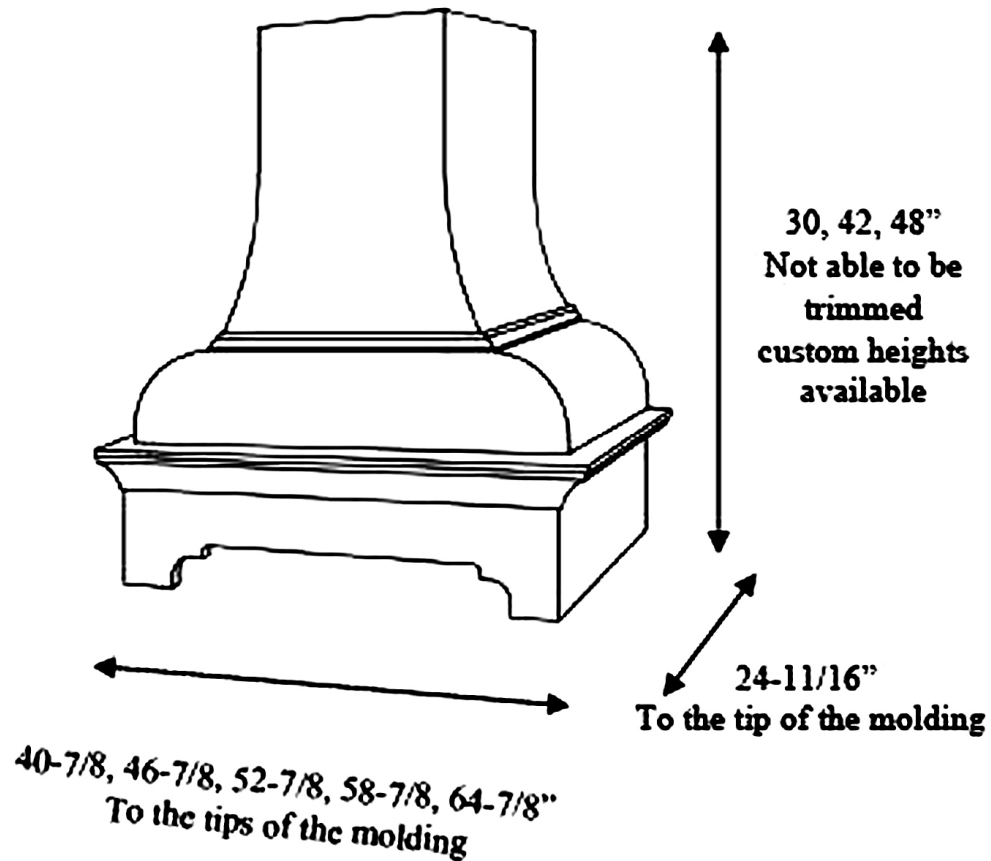

The D-series hood is sized to work with ranges up to 60". Custom widths are available, custom depths are not. The standard hood is available in three heights. The hood should not be trimmed in the field. Custom heights are available. Optional delete veneer (ODV) for upper chimney gives a hood faced with 3/8" Lauan to receive your special plaster finish.

Order liners 4 7/8" smaller than the hood for proper fit (40 7/8" hood – order 36" liner)

D-SERIES WITH ARCHED RAISED PANEL BASE

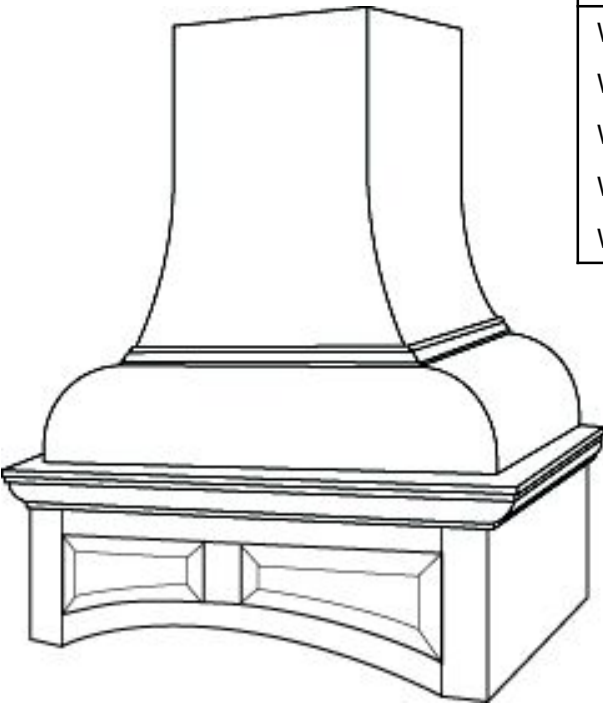

30" HIGH	48" HIGH	42" HIGH
WHDRA40.87530	WHDRA40.87548	WHDRA40.87542
WHDRA46.87530	WHDRA46.87548	WHDRA46.87542
WHDRA52.87530	WHDRA52.87548	WHDRA52.87542
WHDRA58.87530	WHDRA58.87548	WHDRA58.87542
WHDRA64.87530	WHDRA64.87548	WHDRA64.87542

D-SERIES WITH DECORATIVE PANEL BASE

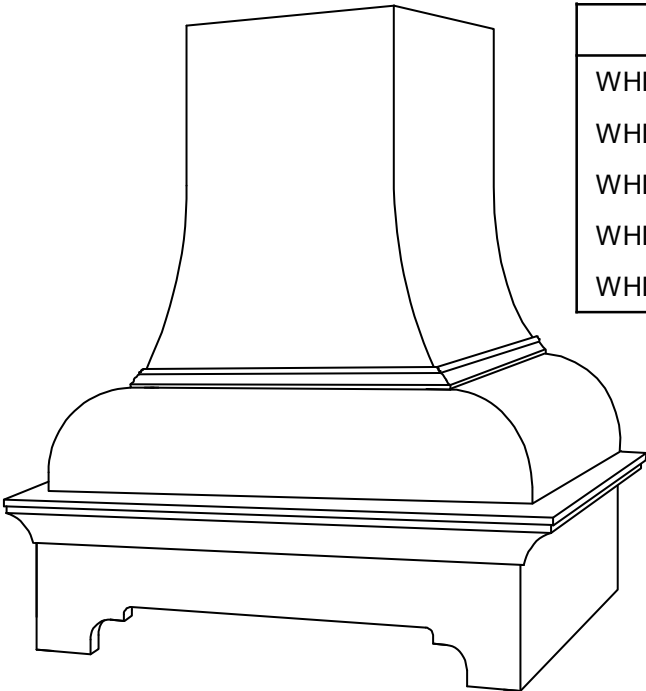

30" HIGH	48" HIGH	42" HIGH
WHDDP140.87530	WHDDP140.87542	WHDDP140.87548
WHDDP146.87530	WHDDP146.87542	WHDDP146.87548
WHDDP152.87530	WHDDP152.87542	WHDDP152.87548
WHDDP158.87530	WHDDP158.87542	WHDDP158.87548
WHDDP164.87530	WHDDP164.87542	WHDDP164.87548

E-Series Range Hoods

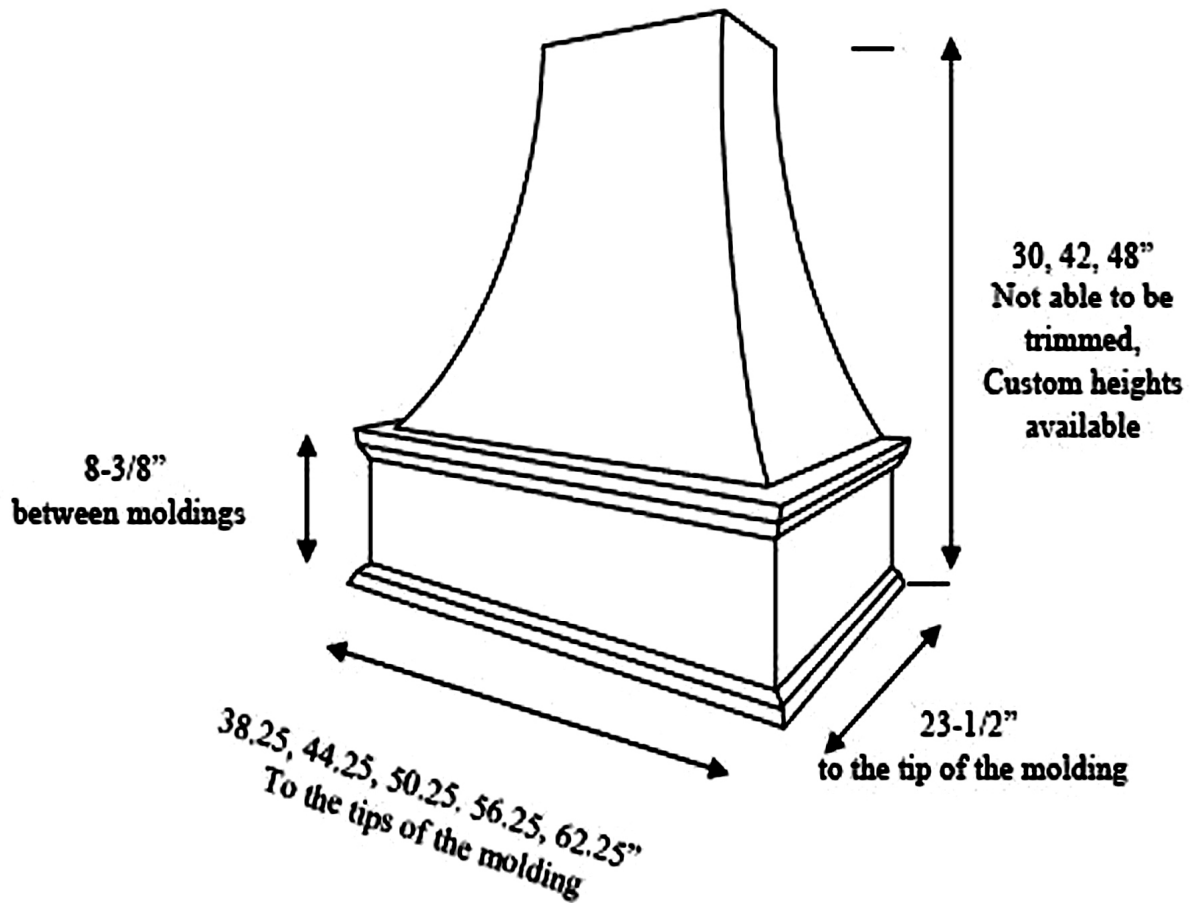

The E-series hood is sized to work with ranges up to 60". Custom widths are available, custom depths are not. The standard hood is available in three heights. The hood should not be trimmed in the field. Custom heights are available. Optional delete veneer (ODV) for upper chimney gives a hood faced with 3/8" Lauan to receive your special plaster finish.

Order liners 2 1/4" smaller than the hood for proper fit (38 1/4" hood – order 36" liner)

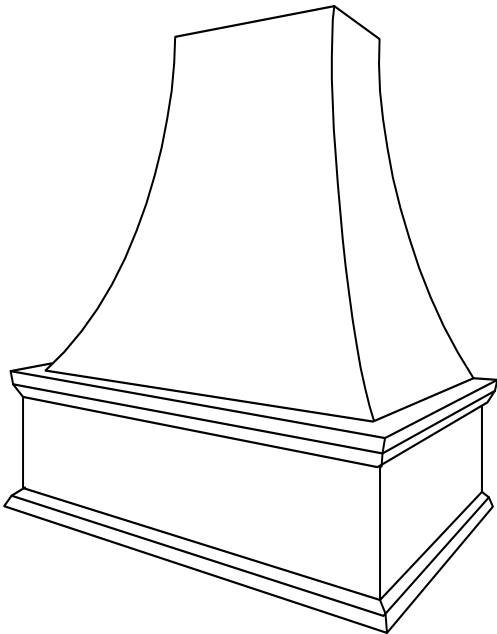

30" HIGH	42" HIGH	48" HIGH
WHE38.2530	WHE38.2542	WHE38.2548
WHE44.2530	WHE44.2542	WHE44.2548
WHE50.2530	WHE50.2542	WHE50.2548
WHE56.2530	WHE56.2542	WHE56.2548
WHE62.2530	WHE62.2542	WHE62.2548

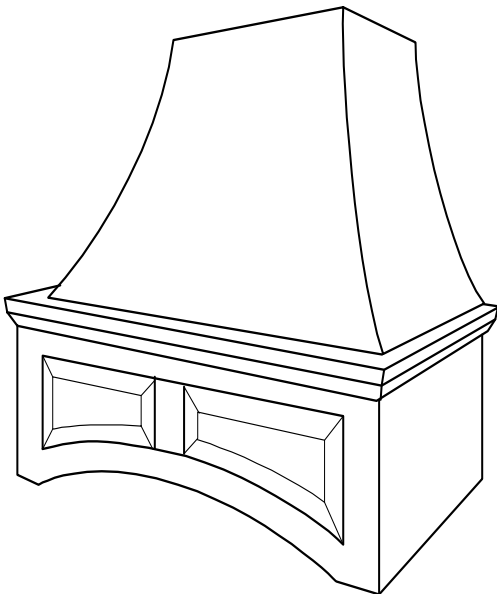

30" HIGH	42" HIGH	48" HIGH
WHERA38.2530	WHERA38.2542	WHERA38.2548
WHERA44.2530	WHERA44.2542	WHERA44.2548
WHERA50.2530	WHERA50.2542	WHERA50.2548
WHERA56.2530	WHERA56.2542	WHERA56.2548
WHERA62.2530	WHERA62.2542	WHERA62.2548

Professional Mesh Series Ventilation (PML)

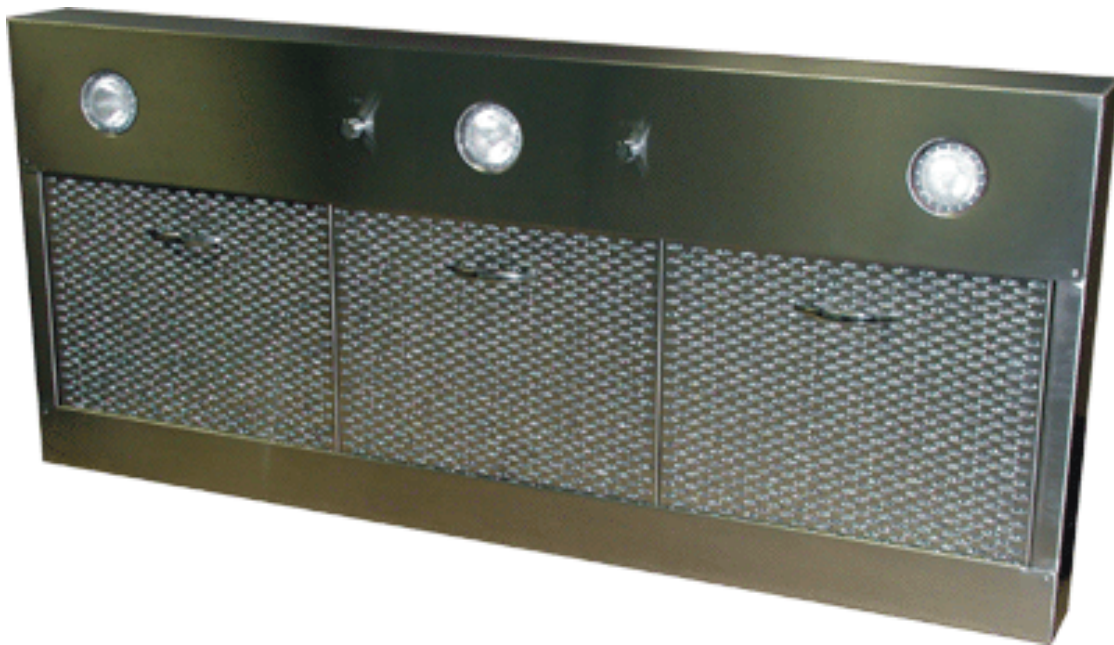

These powerful ventilation systems are manufactured using 22 gauge 303 series stainless steel, perforated stainless filter system, variable speed motor control and dimmer controlled halogen lighting. They are UL listed, and the filters are dishwasher safe.

Your choice of powerful blowers include internal 400, 600 or 1000 CFM, remote 600, 1200 or 1500 CFM, or a 1000 CFM inline. Several standard size liners include widths of 28-3/8" (30"), 34-3/8" (36"), 40-3/8" (42"), 46-3/8" (48"), 52-3/8" (54"), 58-3/8" (60"). Custom sizes are available.

30", 36", & 42" wide liners have 2 halogen lights. Larger widths have 3 lights.

Professional Baffle Series Ventilation (PSL)

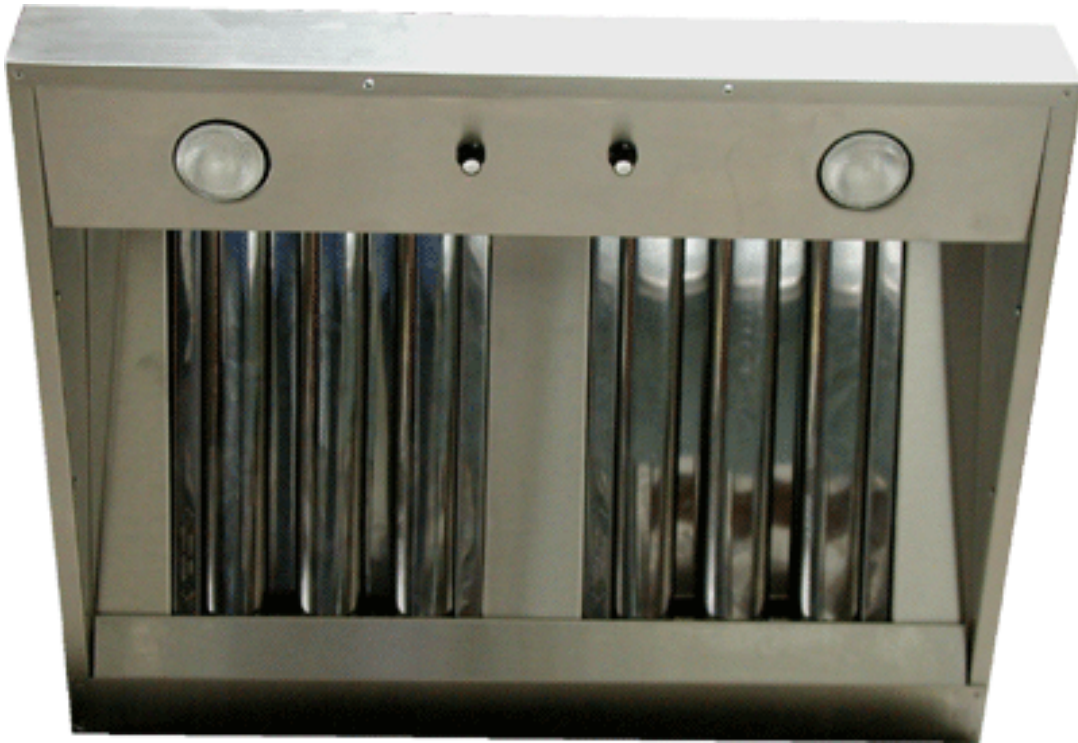

These powerful ventilation systems are manufactured using 22 gauge 303 series stainless steel, a polished stainless steel baffle filter system, variable speed motor control and dimmer controlled halogen lighting. They are UL listed, and the filters are dishwasher safe.

They employ double wall construction. Your choice of powerful blowers include internal 400, 600 or 1000 CFM, external 600, 1200 or 1500 CFM, or 1000 CFM inline. Several standard size liners include widths of 28-3/8" (30"), 34-3/8" (36"), 40-3/8" (42"), 46-3/8" (48"), 52-3/8" (54"), 58-3/8" (60") with a 22-1/2" depth. Custom sizes are available. Professional Ventilators can be used with most hoods.

If ordered with arched bases on the G,T,I,E,W,H,S,J ,or A, the base height will be increased by 2". This is done at no charge.

30", 36", & 42" wide liners have 2 halogen lights. Larger widths have 3 lights.

Professional Series Ventilation

Duct height centered in hood 2" off the wall

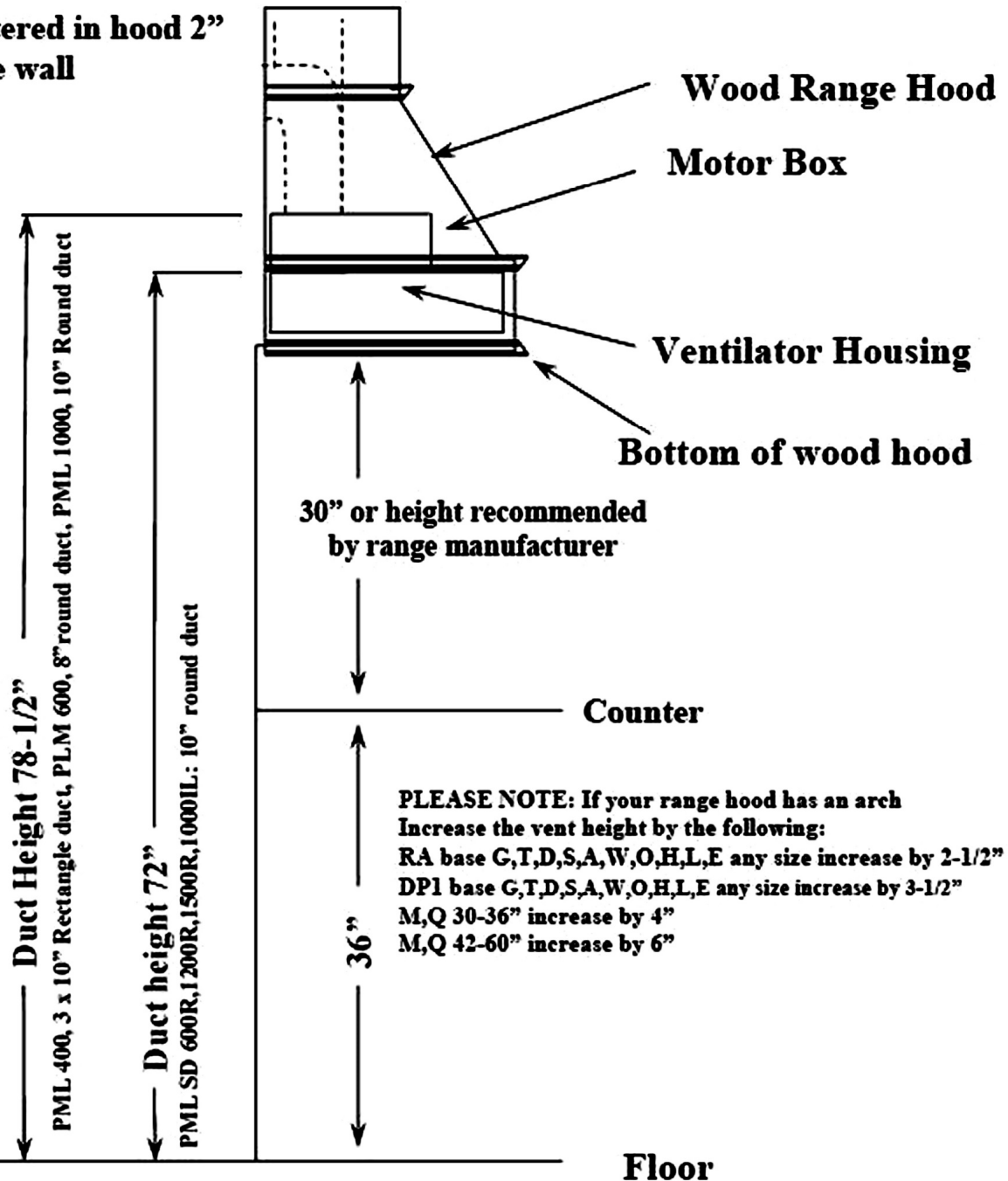

Diagram depicts Professional Mesh Liner, increase installed duct heights on the Professional Baffle Liner by 2-3/4"

Please note some cooktops require the range hood to be mounted higher than 30", see manufacturers specifications

****Please check your local building code before placing an order. Range Hoods and Liner ventilators are subject to local building codes. It is your responsibility to ensure Stanisci Design Wood Range Hoods and liner/ventilators meet your local building code and/or the appliance manufacturers specifications.**

We strongly suggest that you purchase the wood hood with the ventilation unit. This will assure you that the liner and vent work in the space within the hood.

All orders for hoods with ventilation will include a secondary in-line damper that must be used to form an air lock between the hood and the outside. This will greatly reduce the natural movement of air between areas of colder and warmer temperatures.

Please be sure to check the available room for ductwork.

Internal 400 CFM	3"x10" rectangle
Internal 600 CFM	8" round
Internal 1000 CFM	10" round
In-line 1000 CFM	10" round
External 600 CFM	10" round
External 1200 CFM	10" round
External 1500 CFM	10" round

Always be sure to check your local building code and follow the appliance recommendations for ventilation and distance to combustible surfaces.

Ventilation units are covered by a 2-year in home warranty from the manufacturer, Modernaire.

External blowers are superior to internal or in-line units because they pull the air through the duct, rather than push it. External units also reduce the overall system noise since the motor is located outside the home. To further minimize the noise, keep the duct run as straight as possible.

Professional Mesh Series Ventilation (PML)



	400 CFM	600 CFM	1000 CFM	1000 CFM	600 CFM	1200 CFM	1500 CFM
	Interior	Interior	Interior	Inline	Remote	Remote	Remote
30"	PML400-30	PML600-30					
36"	PML400-36	PML600-36	PML1000-36	PML1000IL-36	PML600R-36	PML1200R-36	PML1500R-36
42"	PML400-42	PML600-42	PML1000-42	PML1000IL-42	PML600R-42	PML1200R-42	PML1500R-42
48"	PML400-48	PML600-48	PML1000-48	PML1000IL-48	PML600R-48	PML1200R-48	PML1500R-48
54"	PML400-54	PML600-54	PML1000-54	PML1000IL-54	PML600R-54	PML1200R-54	PML1500R-54
60"	PML400-60	PML600-60	PML1000-60	PML1000IL-60	PML600R-60	PML1200R-60	PML1500R-60

Professional Baffle Series Ventilation (PSL)

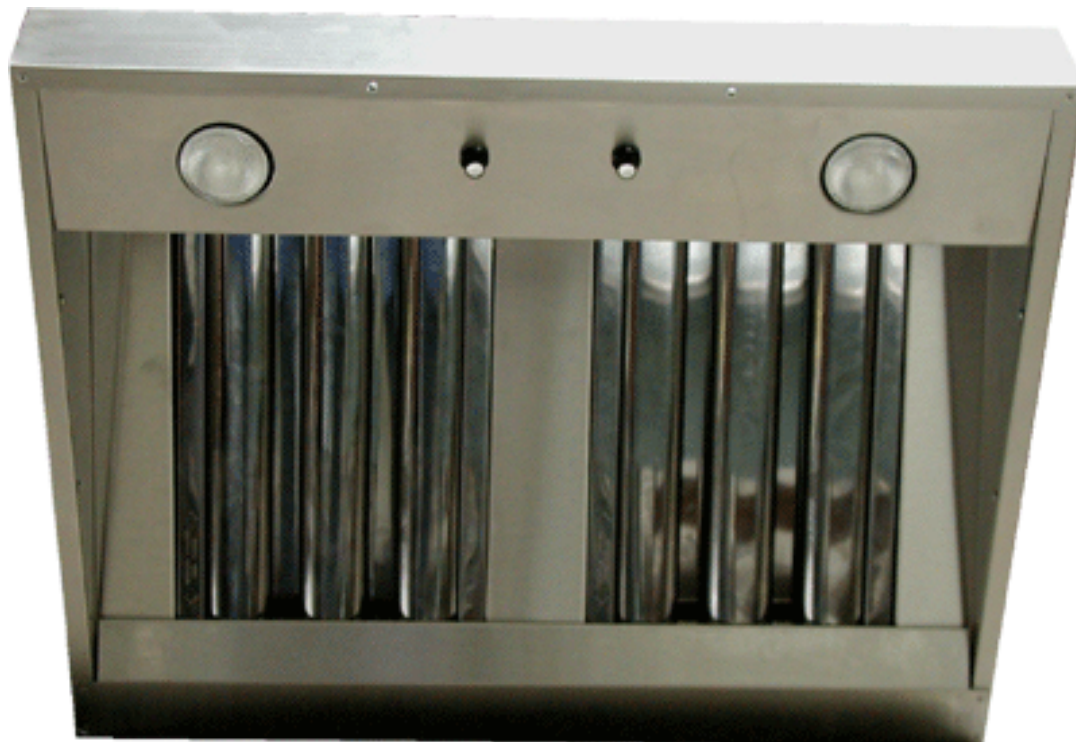

	400 CFM	600 CFM	1000 CFM	1000 CFM	600 CFM	1200 CFM	1500 CFM
	Interior	Interior	Interior	Inline	Remote	Remote	Remote
30"	PSL400-30	PSL600-30	PSL1000-30	PSL1000IL-30	PSL600R-30	PSL1200R-30	PSL1500R-30
36"	PSL400-36	PSL600-36	PSL1000-36	PSL1000IL-36	PSL600R-36	PSL1200R-36	PSL1500R-36
42"	PSL400-42	PSL600-42	PSL1000-42	PSL1000IL-42	PSL600R-42	PSL1200R-42	PSL1500R-42
48"	PSL400-48	PSL600-48	PSL1000-48	PSL1000IL-48	PSL600R-48	PSL1200R-48	PSL1500R-48
54"	PSL400-54	PSL600-54	PSL1000-54	PSL1000IL-54	PSL600R-54	PSL1200R-54	PSL1500R-54
60"	PSL400-60	PSL600-60	PSL1000-60	PSL1000IL-60	PSL600R-60	PSL1200R-60	PSL1500R-60

Optional Corbels for W-Series and O-Series Hoods

Acanthus Corbels



COR-AC2
5 x 5 x 10 ½

Grape & Leaf Corbels



COR-GR2
4 ¾ x 5 x 9 ½

Provincial Corbels



CBL-PRW3
4 ½ x 4 ¾ x 10 ½

Traditional Corbels



COR-TT2
4 ½ x 5 x 10

Arts and Crafts Corbels



CBL-ART3
5 x 5 x 10